

PLAT IDENTIFICATION SHEET

RECEPTION #: 01032653

DATE: 4-18-01

TIME 10:17

FEE: \$ 70.⁰⁰ (7 P)

GRANTOR:
(OWNER/SIGNER)

Castle Rock Lifelong Learning
Center & Town of Castle Rock

GRANTEE:

(SUBDIVISION NAME OR NAME OF PLAT)

Redhawk Filing #1
3rd Amend Lots 1 & 2

LEGAL:

(SECTION-TOWNSHIP-RANGE)

3-8-67

NEW SUBDIVISION ABBREV: _____

LEGAL DESCRIPTION

LOT 1 AND LOT 2 OF RED HAWK FILING NO. 1, THIRD AMENDMENT, SUBDIVISION, A PLAT RECORDED IN THE OFFICIAL RECORDS OF THE DOUGLAS COUNTY CLERK AND RECORDER AT RECEPTION NO. 00077096.

A PARCEL OF LAND LOCATED IN THE EAST HALF OF SECTION 3, TOWNSHIP 8 SOUTH, RANGE 67 WEST, OF THE SIXTH PRINCIPAL MERIDIAN, TOWN OF CASTLE ROCK, COUNTY OF DOUGLAS, STATE OF COLORADO.

OWNERSHIP CERTIFICATION:

THE UNDERSIGNED ARE ALL OF THE OWNERS OF CERTAIN LANDS KNOWN HEREIN AS THE CASTLE ROCK LIFELONG LEARNING CENTER PD IN THE TOWN OF CASTLE ROCK.

CASTLE ROCK LIFELONG LEARNING CENTER:

Authorized Representative (NOTARIZED SIGNATURE)

SIGNED THIS 7th DAY OF March, 2001

STATE OF COLORADO, County of Douglas. The foregoing instrument was acknowledged before me this 7th day of March, 2001, by Daniel J. Danuser, My commission expires 11-22-01. WITNESS my hand and official seal.

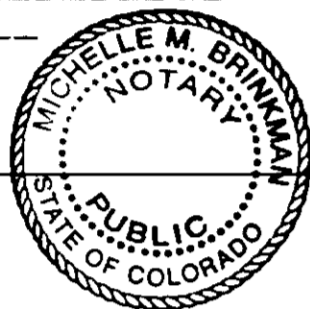

TOWN OF CASTLE ROCK:

Authorized Representative (NOTARIZED SIGNATURE)

SIGNED THIS 2nd DAY OF April, 2001

STATE OF COLORADO, County of Douglas. The foregoing instrument was acknowledged before me this 2nd day of April, 2001, by Al Parker as Mayor of the Town of Castle Rock. My commission expires 9-21-03. WITNESS my hand and official seal.

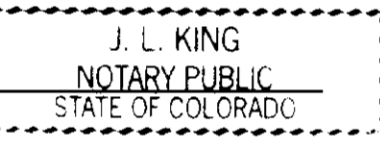

LIEN HOLDER SUBORDINATION CERTIFICATE:

THE UNDERSIGNED ARE ALL THE MORTGAGEES AND LIEN HOLDERS OF CERTAIN LANDS KNOWN HEREIN AS THE CASTLE ROCK LIFE LONG LEARNING CENTER PD IN THE TOWN OF CASTLE ROCK.

THE UNDERSIGNED BENEFICIARY OF THE LIEN CREATED BY INSTRUMENT RECORDED ON 11-12-00 IN 1920 BOOK AT PAGE 122 DOUGLAS COUNTY, COLORADO, SUBORDINATE THE SUBJECT LIEN TO THE TERMS, CONDITIONS AND RESTRICTIONS OF THE DOCUMENT: THE BANK OF CHERRY CREEK, N.A. AS TRUSTEE

SIGNED THIS 7th DAY OF March, 2001.

STATE OF COLORADO, County of DEVER. The foregoing instrument was acknowledged before me this 7th day of MARCH, 2001, by KENNETH S. BUCKUS FOR THE BANK OF CHERRY CREEK, N.A. AS TRUSTEE. My commission expires August 8, 2003. WITNESS my hand and official seal.

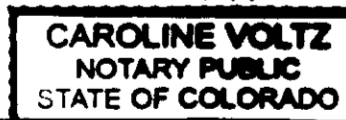

SURVEYOR'S CERTIFICATE

I, Dwayne M. Purcell, A REGISTERED PROFESSIONAL LAND SURVEYOR IN THE STATE OF COLORADO, DO HEREBY CERTIFY THAT THE SURVEY AND LEGAL DESCRIPTION REPRESENTED BY THE CASTLE ROCK LIFELONG LEARNING CENTER FINAL PD SITE PLAN WAS MADE UNDER MY SUPERVISION AND THE MONUMENTS SHOWN THEREON ACTUALLY EXIST AND THIS SITE PLAN ACCURATELY REPRESENTS THAT SURVEY.

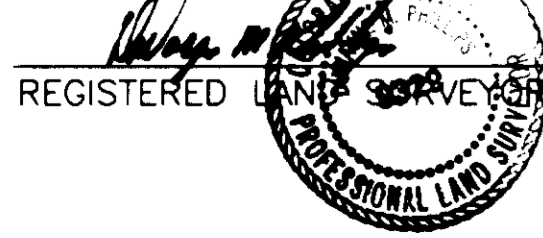

RED HAWK FILING NO. 1, THIRD AMENDMENT, LOTS 1 & 2 FINAL PD SITE PLAN
A PARCEL OF LAND LOCATED IN THE EAST HALF OF SECTION 3, TOWNSHIP 8 SOUTH, RANGE 67 WEST, OF THE SIXTH PRINCIPAL MERIDIAN, TOWN OF CASTLE ROCK, COUNTY OF DOUGLAS, STATE OF COLORADO

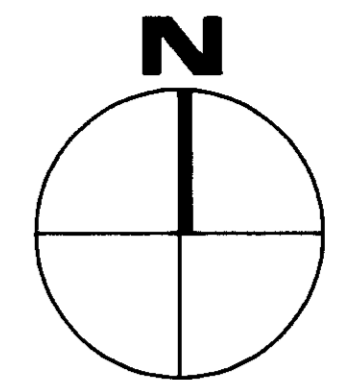

TOWN CERTIFICATION

A. STATEMENT OF PLANNING AND DEVELOPMENT DIRECTOR'S APPROVAL:

THIS PLAT WAS APPROVED BY THE PLANNING AND DEVELOPMENT DIRECTOR OF THE TOWN OF CASTLE ROCK, COLORADO, THE 21st DAY OF March, 2001.

DIRECTOR OF PLANNING AND DEVELOPMENT: DATE

B. DOUGLAS COUNTY CLERK AND RECORDER'S CERTIFICATE

THIS PLAT WAS FILED FOR RECORD IN THE OFFICE OF THE COUNTY CLERK AND RECORDER OF DOUGLAS COUNTY AT 10:17 AM ON THE 17th DAY OF APRIL, 2001. IN BOOK 1032, PAGE 11, MAP 1, RECEPTION NO. 01032653

DOUGLAS COUNTY CLERK AND RECORDER BY: Sherry Muehlhoff Deputy



TITLE CERTIFICATION:

I, LARYCE L. NITSCHE, AN AUTHORIZED REPRESENTATIVE OF LAND TITLE GUARANTEE Co. A TITLE INSURANCE COMPANY LICENSED TO DO BUSINESS IN THE STATE OF COLORADO, HAVE MADE AN EXAMINATION OF THE PUBLIC RECORDS AND STATE THAT ALL OWNERS, MORTGAGEES AND LIEN HOLDERS OF THE PROPERTY ARE LISTED IN THE CERTIFICATE OF OWNERSHIP AND LIEN HOLDER SUBORDINATION CERTIFICATE, except lease recorded in book 1920 at page 174.

SIGNED THIS 7th DAY OF March, 2001

Authorized Representative (NOTARIZED SIGNATURE) Title Officer Land Title Guaranty Company Title Insurance Company

STATE OF COLORADO, County of Douglas. The foregoing instrument was acknowledged before me this 7th day of March, 2001, by Laryce L. Nitsch, My commission expires 9-1-03. WITNESS my hand and official seal.

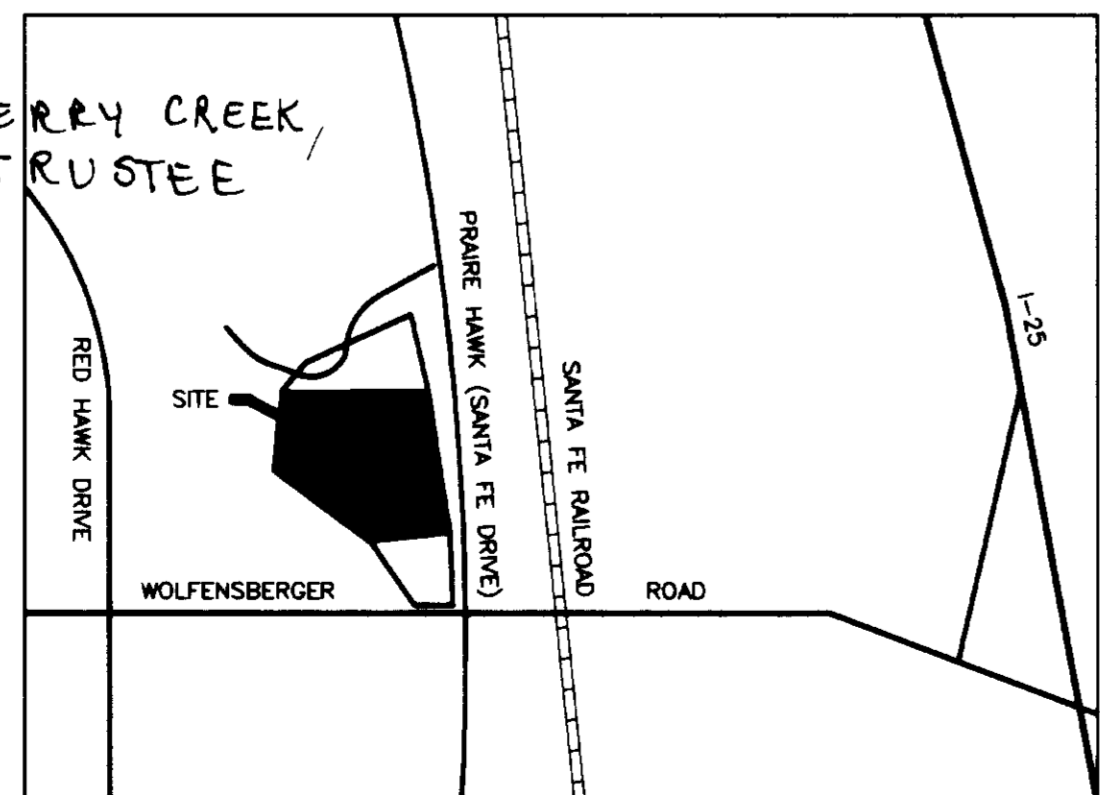
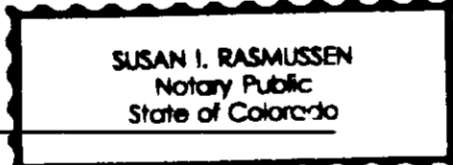

SUMMARY TABLE with sections for SITE INFORMATION, PARKING INFORMATION, and BUILDING INFORMATION.

PROJECT TEAM listing roles such as OWNER, MECHANICAL ENGINEER, CIVIL ENGINEER, ELECTRICAL ENGINEER, ARCHITECT, SURVEYOR, and STRUCTURAL ENGINEER.

NARRATIVE STATEMENT describing the vision for the Academy Charter School, the donated site, and the design concept.

SHEET INDEX table listing sheet numbers and titles: 1 COVER SHEET, 2 SITE PLAN, 3 LANDSCAPE PLAN, 4 GRADING/ DRAINAGE PLAN, 5 UTILITIES PLAN, 6 BUILDING ELEVATIONS, 7 TRAFFIC SIGN ELEVATIONS/ TRAFFIC SIGN SECTIONS.

RED HAWK FILING NO. 1, THIRD AMENDMENT, LOTS 1 & 2 CASTLE ROCK LIFELONG LEARNING CENTER FINAL PD SITE PLAN

ISSUE RED HAWK FILING NO. 1 THIRD AMENDMENT LOTS 1 & 2 CASTLE ROCK LIFELONG LEARNING CENTER FINAL SUBMITTAL FINAL PD FEB. 19, 2001

SLATER - PAULL & ASSOCIATES, INC. Architecture - Preservation - Interior Design

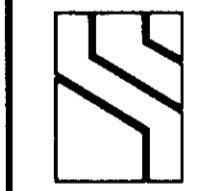

CASTLE ROCK LIFELONG LEARNING CENTER COVER SHEET

JOB NUMBER: 9945030

1 SHEET NUMBER:

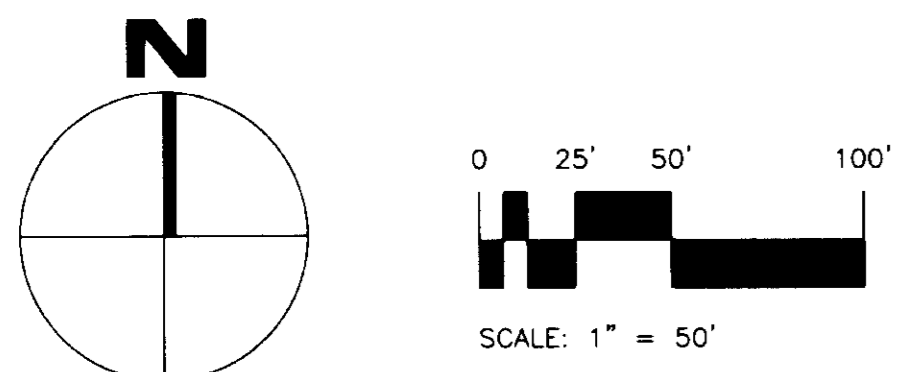

RED HAWK FILING NO. 1, THIRD AMENDMENT, LOTS 1 & 2 FINAL PD SITE PLAN

A PARCEL OF LAND LOCATED IN THE EAST HALF OF SECTION 3, TOWNSHIP 8 SOUTH, RANGE 67 WEST, OF THE SIXTH PRINCIPAL MERIDIAN, TOWN OF CASTLE ROCK, COUNTY OF DOUGLAS, STATE OF COLORADO

PLANT NOTES

- All plants are to be nursery grown stock from growers located in USDA hardness zones 1,2,3 or 4.
- Irrigated lawn is to be turf type tall fescue seed, installed by hydro-seeding. Lay sod 1" lower than adjacent paving grade or edger except in the center of a swale where drainage would be impeded. Match all proposed turf to existing turf.
- Install 4" deep wood chips from tree & brush trimmings (no pole peelings) in all single trees and where noted on plan. Sample of wood chips to be approved by Landscape Architect prior to installation.
- Soil preparation shall consist of equal parts of composted cow manure at a rate of 3 cu. yds. per 1000 sq. ft. and tilled to a depth of 6"-9". Fertilizers shall include:
 - Commercial fertilizer having an analysis of 46% available nitrogen (Urea & sulphur-coated Urea only) (46-0-0) in sufficient quantity to apply at a rate of 50 lbs. nitrogen per acre.
 - Treble phosphate (0-46-0) in sufficient quantity to apply at a rate of 650 lbs. phosphate per acre.
- Separate turf from shrub beds with staked 1/8"x4" plastic edging.
- Install mixed cobble over geotextile fabric (Warrens' terrabond 1112 or approved equal) where noted on plan; no fabric is to be visible. Excavate soil where necessary to keep rock beds no more than 1" above finished grade. Rock selection to be approved by Landscape Architect prior to installation.
- The following are minimum distances that plant materials can be placed from adjacent walls, fences, or paved areas.
 - Evergreen trees - 8'
 - Large shrubs - 4'
 - Medium shrubs - 2 1/2'
 - Groundcover - 12"
- Any plant substitutions are to be approved by Landscape Architect prior to installation.
- All turf to be watered using an underground automatic irrigation system connected to the domestic water supply. All trees, shrubs, and groundcover to be watered using an underground drip system. Irrigation system must comply with TCR Water Use Management Program Criteria, including irrigation must occur every third day between 11pm and 4 am; rain shut off sensors are required; battery backup system is required; application rate must not exceed 1.5" per week.
- Installation of irrigation system to include shut down of system at end of growing season & start up of system in spring.
- Contractor to submit the irrigation plan to landscape architect for approval before installation.
- Contractor to guarantee all work for 1 year after installation.
- The contractor shall be solely responsible for safety in, on or about the project site. Any damage to adjacent property or utilities, not designated for removal, relocation or replacement, shall be repaired and/or replaced by the contractor at the contractor's expense.
- The contractor shall be responsible for obtaining any permits or licenses required for the performance of the work as applicable to the project. A permit is required to installation of new sod and seed in order to irrigate outside of prescribed parameters.
- The landscape architect and/or owner make no warranty as to the correctness and/or completeness of the existing utility locations shown or not shown on the plans. The contractor shall be responsible for field verifying the horizontal and vertical location of all existing utilities including water, sewer, storm drains, gas transmission lines, and other utilities above and below the surface that may affect the project. Should any discrepancy or conflict be discovered the contractor shall notify the landscape architect immediately, and shall not continue construction until said conflict can be resolved in writing.
- The contractor shall notify all utility companies at least 48 hours prior to beginning construction to verify depth and location of all utilities.
- Any construction debris or mud-tracking in the public right-of-way resulting from the work shall be removed immediately by the contractor.
- The contractor shall provide all lights, signs, barricades, flagmen and other devices necessary to provide for the public safety on and about the site. The contractor shall furnish appropriate traffic control and safety measures in accordance with the requirements of applicable Highways and Transportation authority.
- If there is a discrepancy between plant quantities on plant legend, plan takes precedence. The number of symbols shown takes precedence over the quantity in the call-out, if there is a discrepancy. Contractor shall be responsible for his own construction quantity estimates.
- Landscape should not occur in TCR water and sanitary sewer easements.

PLANT LIST

SYMBOL	COMMON NAME Botanical Name	QUANTITY	SIZE
DECIDUOUS SHADE TREES:			
APA	AUTUMN PURPLE AMERICAN ASH <i>Fraxinus americana</i> 'Purple Ash'	3	2 1/2" B&B
ABM	AUTUMN BLAZE MAPLE <i>Acer x freemanii</i> 'Jeffersred'	8	2 1/2" B&B
PAT	PATMORE ASH <i>Fraxinus penn. lan.</i> 'Patmore'	6	2 1/2" B&B
WHB	WESTERN HACKBERRY <i>Celtis occidentalis</i>	6	2 1/2" B&B
	TOTAL	23	
EVERGREEN TREES			
AUP	AUSTRIAN PINE <i>Pinus nigra</i>	8	8' B&B
BCP	BRISTLECONE PINE <i>Pinus aristata</i>	8	6' B&B
PYP	PINYON PINE <i>Pinus cembroides edulis</i>	6	6' B&B
	TOTAL	22	
ORNAMENTAL TREES:			
CTH	COCKSPUR THORNLESS HAWTHORN <i>Crataegus crus-galli</i> 'inermis'	2	1 1/2" B&B
CCP	CHANTICLEER PEAR <i>Pyrus calleryana</i> 'Chanticleer'	8	1 1/2" B&B
PFC	PRAIRIE FIRE CRABAPPLE <i>Malus sp.</i> 'Prairie Fire'	11	1 1/2" B&B
SSC	SPRING SNOW CRABAPPLE <i>Malus sp.</i> 'Spring Snow'	7	1 1/2" B&B
	TOTAL	28	
SHRUBS			
BCJ	BLUE CHIP JUNIPER <i>Juniperus horizontalis</i> 'Blue Chip'	26	#5 cntnr.
BFJ	BUFFALO JUNIPER <i>Juniperus sabinna</i> 'Buffalo'	21	#5 cntnr.
DKL	DWARF KOREAN LILAC <i>Syringa meyeri</i>	8	#5 cntnr.
LPS	LITTLE PRINCESS SPIREA <i>Spiraea japonica</i> 'Little Princess'	14	#5 cntnr.
MGP	MUGHO PINE <i>Pinus mugho</i>	8	#5 cntnr.
RTD	RED TWIG DOGWOOD <i>Cornus sericea</i> 'Bailey'	5	#5 cntnr.
SVB	SERVICEBERRY <i>Amelanchier canadensis</i>	16	#5 cntnr.
TFR	THE FAIRY ROSE <i>Rosa polyantha</i> 'The Fairy'	18	#5 cntnr.
TLS	THREE LEAF SUMAC <i>Rhus trilobata</i>	18	#5 cntnr.
	TOTAL	134	

LANDSCAPE SUMMARY

- GROSS SITE AREA = 316,875 S.F. = 7.27 ACRES
- 10% OF GSA = REQUIRED LANDSCAPE AREA = 31,688 S.F.
- PROVIDED LANDSCAPE AREA = 191,526 S.F.
- OTHER LANDSCAPE REQUIREMENTS
- 2 TREES/4 SHRUBS FOR EVERY 1,000 S.F. OF REQUIRED LANDSCAPE AREA
- REQUIRED LANDSCAPE = 64 TREES/128 SHRUBS.
- PROVIDED LANDSCAPE = 66 TREES AND 131 SHRUBS

LANDSCAPE LEGEND

SYMBOL	QUANTITY
(Circle with dot)	SHADE TREE 23
(Circle with cross)	ORNAMENTAL TREE 28
(Circle with vertical lines)	EVERGREEN TREE 22
(Circle with horizontal lines)	SHRUBS 134
(Square with diagonal lines)	IRRIGATED SEED 91,060 s.f.
(Square with horizontal lines)	NON-IRRIGATED NATIVE SEED 97,756 s.f.
(Square with vertical lines)	UNDISTURBED AREA PHASE I 124,531 s.f.
(Square with diagonal lines)	COBBLE MULCH 2,710 s.f.
(Square with horizontal lines)	3/4" GRAVEL 1,415 s.f.

EVERGREEN TREE

NOTE: SET ROOT BALL OF EVERGREEN TREES 4" - 5" ABOVE GRADE. SET ROOT BALL OF DECIDUOUS TREES 2" ABOVE GRADE IN HEAVILY IRRIGATED AREAS (i.e. LAWNS) AND MULCH AS SPECIFIED. INSTALL A 6" HIGH BERM AROUND TREES TO CREATE A WATERING BASIN IN NON-IRRIGATED AREAS ONLY.

4" DEEP WOOD CHIP MULCH FLUSH WITH SOD AT EDGE.

3 EQUALLY SPACED 24" STEEL STAKES WITH WHITE TOPS. SET FLUSH WITH GRADE. FLAG WIRE WITH 3/4" DIAMETER WHITE PIPE.

REMOVE BURLAP FROM TOP 1/3 OF BALL. REMOVE BASKETS COMPLETELY.

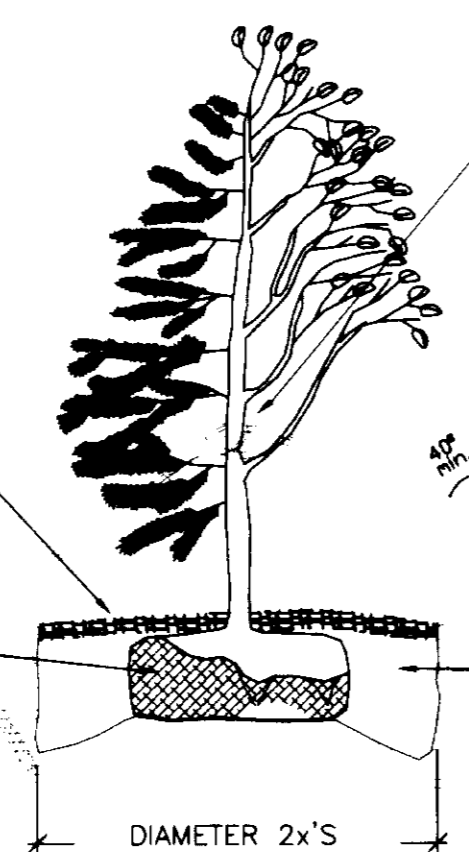

TREE PLANTING DETAIL

NOT TO SCALE

DECIDUOUS TREE

PRUNE AS DIRECTED BY OWNER'S REPRESENTATIVE.

WRAP TRUNK FROM GROUND LEVEL TO SECOND BRANCH WITH 4" ASPHALT IMPREGNATED TREE WRAP. SECURE ENDS WITH FLEXIBLE TAPE. (DOUBLE WRAP MAPLES.)

#12 WIRE, DOUBLE AND TWIST, RUN THROUGH AN 18" MINIMUM NEW GARDEN HOSE PLACED OVER FIRST LIMB. WIRE SHOULD BE TAUT, DO NOT OVERTIGHTEN WIRE. FLAG WIRE WITH WHITE 3/4" DIAMETER PIPE.

PREPARED BACKFILL MIXTURE:

- ONE PART COMPOSTED AMMENDMENT PER SPECS.
- THREE PARTS NATIVE SOIL.
- MATERIALS TO BE THOROUGHLY BLENDED.

EVERGREEN SHRUB

PLACE SPREADING EVERGREEN SHRUBS PERPENDICULAR TO SLOPE OF GROUND. LEAVE ENOUGH SPACE UNDER BRANCHES FOR MULCH.

MOUND BACKFILL UNDER ROOTBALL.

REMOVE CONTAINER, SPLIT BOTTOM 1/2 OF BALL, SPREAD AND PLANT.

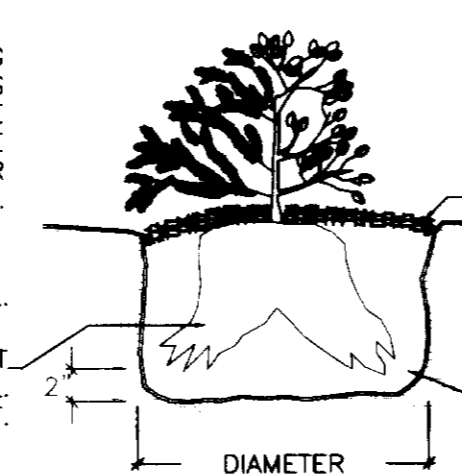

SHRUB PLANTING DETAIL

NOT TO SCALE

DECIDUOUS SHRUB

PRUNE AS DIRECTED BY LANDSCAPE ARCHITECT.

SET SHRUB PLUMB.

4" DEEP WOOD CHIP MULCH OVER MOUNDED BACKFILL. BUILD A 4" BERM AROUND SHRUB TO CREATE A WATERING BASIN IN NON-IRRIGATED AREAS ONLY.

PREPARED BACKFILL MIXTURE:

- ONE PART COMPOSTED AMMENDMENT PER SPECS.
- THREE PARTS NATIVE SOIL.
- MATERIALS TO BE THOROUGHLY BLENDED.

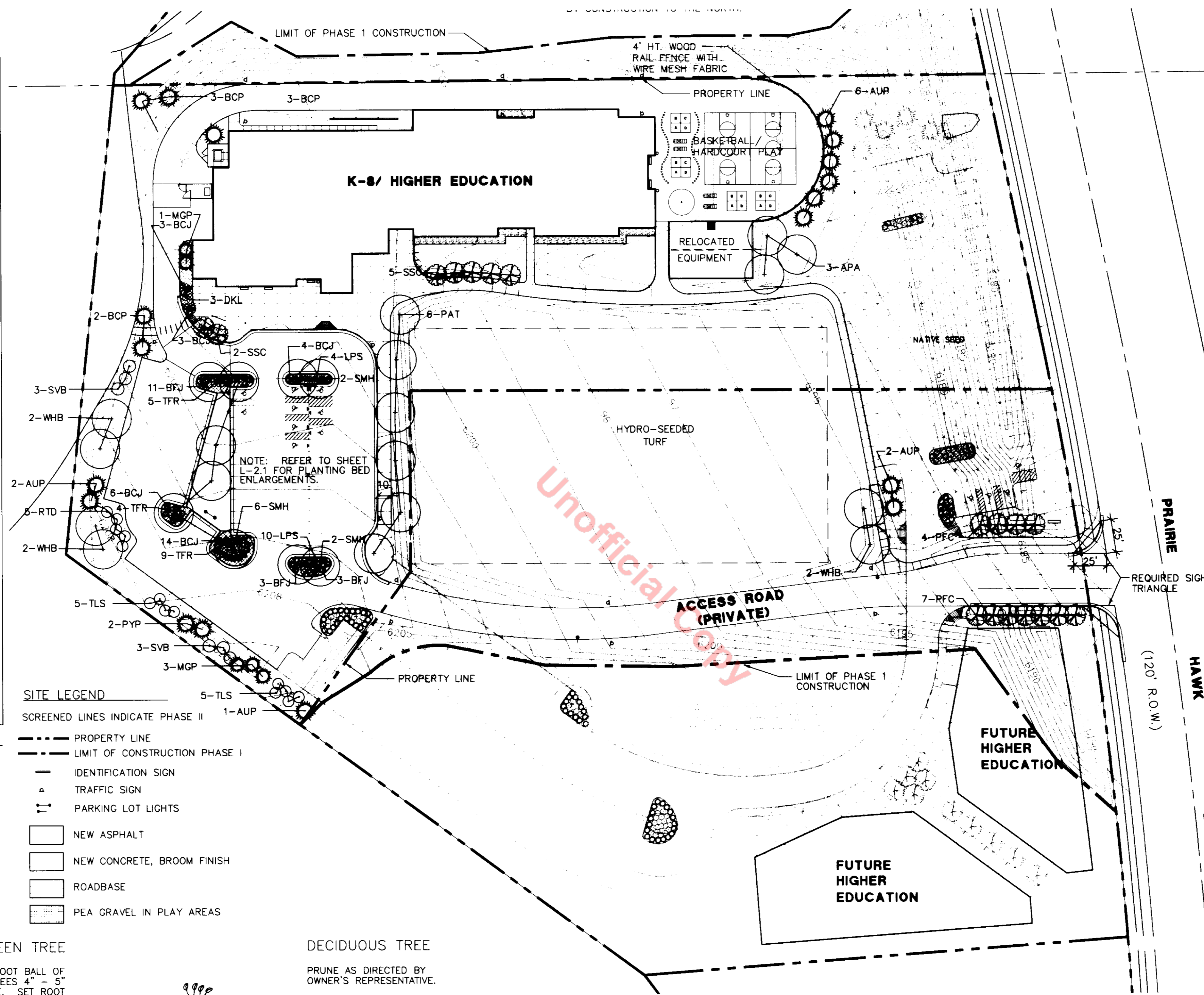

SITE LEGEND

- PROPERTY LINE
- LIMIT OF CONSTRUCTION PHASE I
- IDENTIFICATION SIGN
- ▲ TRAFFIC SIGN
- ⊙ PARKING LOT LIGHTS
- NEW ASPHALT
- NEW CONCRETE, BROOM FINISH
- ROADBASE
- PEA GRAVEL IN PLAY AREAS

NATIVE SEED MIX		
Common Name	Scientific Name	Lbs. PLS/Acre
Western Wheatgrass	<i>Agropyron amabilis</i>	4.00
Prairie June Grass	<i>Koeleria cristata</i>	0.25
Hard Fescue	<i>Festuca longistola</i>	1.00
Blue Grama	<i>Boutelous gracilis</i>	0.50
Little Bluestem	<i>Schizachyrium scorparium</i>	1.00
Intermediate Wheatgrass	<i>Agropyron intermedium</i>	3.00
Sandberg Bluegrass	<i>Poa sandbergii</i>	3.00
Green Needle Grass	<i>Stipa viridula</i>	1.00
		Total 11.25

Add Rocky Mountain Wildflower Mix (supplied by Arkansas Valley Seeds) @ 6 lbs. PLS per acre to grass mix above.

ISSUE
RED HAWK FILING NO. 1
THIRD AMENDMENT, LOTS 1 & 2
CASTLE ROCK LIFELONG
LEARNING CENTER
FINAL SUBMITTAL
FINAL PD
FEB 19, 2001

DESIGN CONCEPTS
Landscape Architects
271 North Public Road, Suite 300
Lafayette, Colorado 80026
www.designconcepts.com

SLATER PAULL & ASSOCIATES, INC.
Architecture · Preservation · Interior Design
ONE PARK CENTRAL, SUITE 400 1515 ARAPAHOE STREET
DENVER, COLORADO 80202
(303) 607-0977 FAX (303) 607-0767

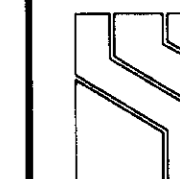

CASTLE ROCK LIFELONG
LEARNING CENTER
CASTLE ROCK, COLORADO
LANDSCAPE PLAN

JOB NUMBER:
9945.030

EHO / BLM / RDL
DRAWN BY: CHECKED BY: APPROVED BY:

2/19/01
DATE:

3

SHEET NUMBER:

3 LANDSCAPE PLAN
1" = 50'

**RED HAWK FILING NO. 1,
THIRD AMENDMENT, LOTS 1 & 2
CASTLE ROCK LIFELONG
LEARNING CENTER
FINAL PD SITE PLAN**

RED HAWK FILING NO. 1, THIRD AMENDMENT, LOTS 1 & 2 FINAL PD SITE PLAN

A PARCEL OF LAND LOCATED IN THE EAST HALF OF SECTION 3, TOWNSHIP 8 SOUTH, RANGE 67 WEST, OF THE SIXTH PRINCIPAL MERIDIAN, TOWN OF CASTLE ROCK, COUNTY OF DOUGLAS, STATE OF COLORADO

RED HAWK FILING NO.1
REC. NO. 9750684
TRACT "E"
(PROPOSED DETENTION FACILITY)

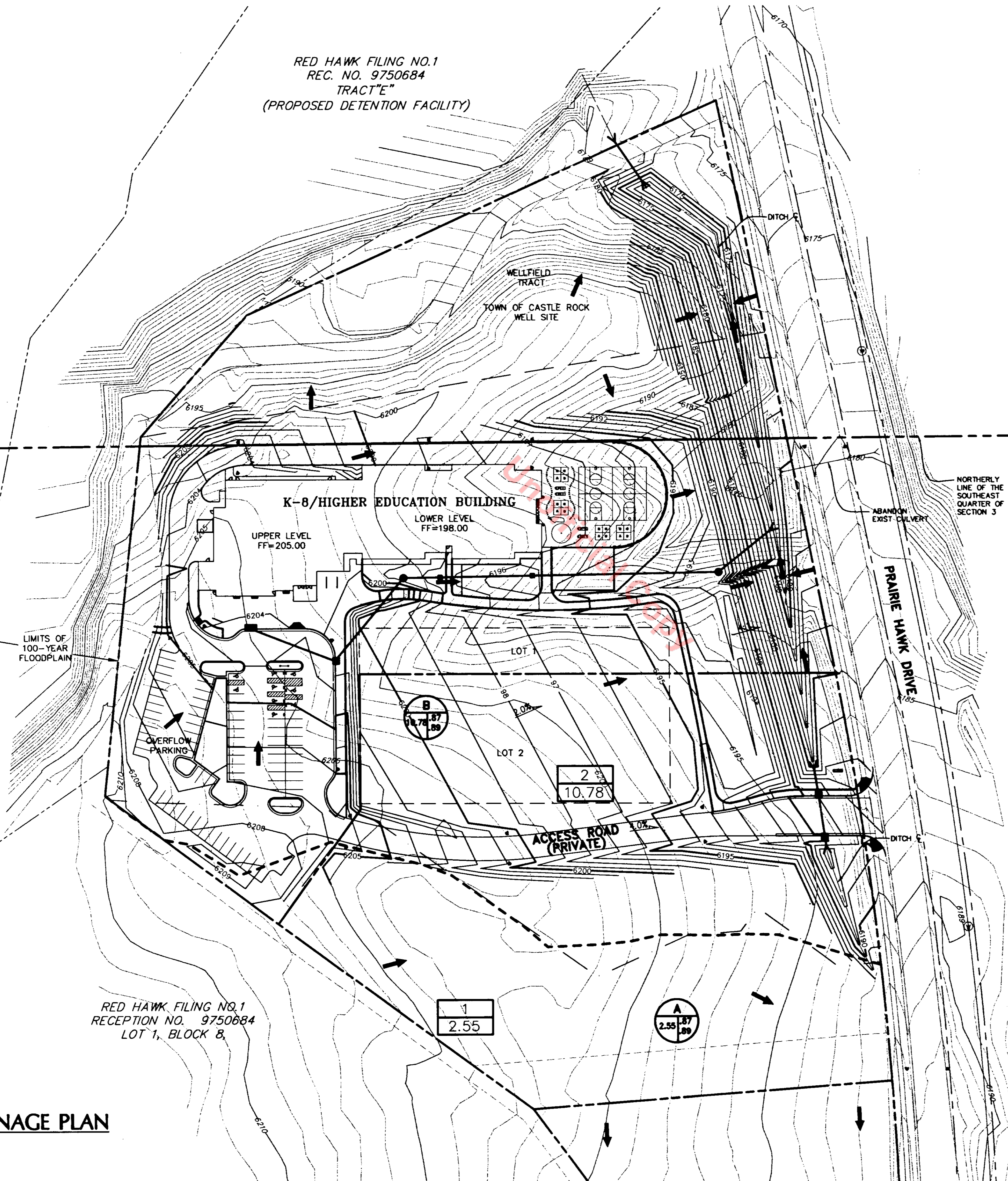

RED HAWK FILING NO.1
REC. NO. 9750684
TRACT "B"

LIMITS OF
100-YEAR
FLOODPLAIN

RED HAWK FILING NO.1
RECEPTION NO. 9750684
LOT 1, BLOCK B.

LEGEND

- PROP. CONTOUR ——— 5510 ———
- EXIST. CONTOUR ——— 5500 ———
- BASIN BOUNDARY ———
- HISTORIC BASIN ———
- DIRECTION OF FLOW →
- DESIGN POINT
- BASIN
- AREA IN ACRES
- HISTORIC BASIN
- AREA IN ACRES

NOTE: HISTORICAL BASIN ACREAGE DETERMINED FROM TRACT "A" ONLY. REFER TO RED HAWK AT THE MEADOWS MASTER DRAINAGE PLAN PREPARED BY ROCKY MOUNTAIN CONSULTANTS, INC. REV. MARCH 1996 FOR THE MASTER HISTORICAL BASIN SIZE.

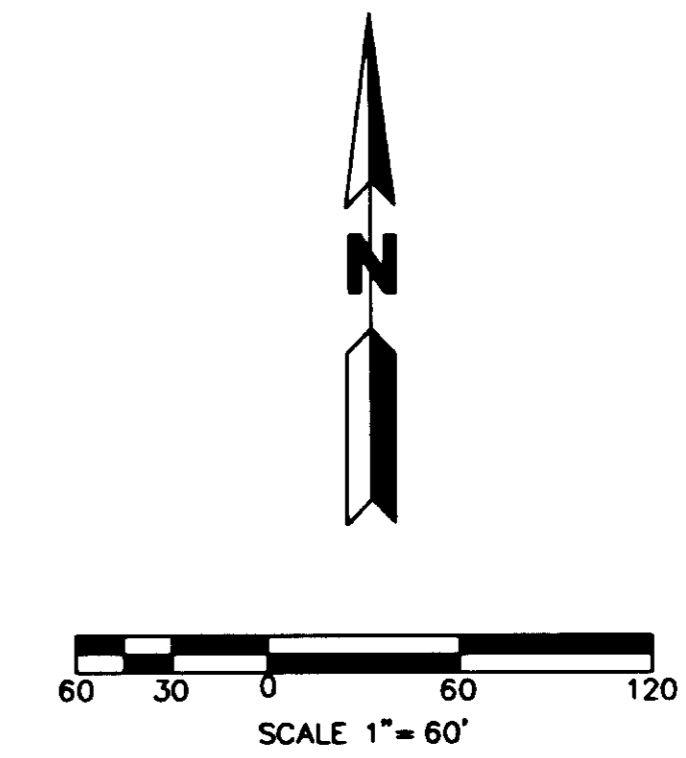

MARTIN/MARTIN assumes no responsibility for utility locations. The utilities shown on this drawing have been plotted from the best available information. It is, however, the contractor's responsibility to field verify the location of all utilities prior to the commencement of any construction.

4 OVERLOT GRADING AND DRAINAGE PLAN

1"=60'

RED HAWK FILING NO. 1, THIRD AMENDMENT, LOTS 1 & 2 CASTLE ROCK LIFELONG LEARNING CENTER FINAL PD SITE PLAN

ISSUE
RED HAWK FILING NO. 1
THIRD AMENDMENT, LOTS 1 & 2
CASTLE ROCK LIFELONG
LEARNING CENTER
FINAL SUBMITTAL
FINAL PD
FEB. 19, 2001

SLATER · PAULL & ASSOCIATES, INC.
Architecture · Preservation · Interior Design
ONE PARK CENTRAL, SUITE 400 1919 ANAPLANE STREET
DENVER, COLORADO 80202
(303) 607-0877 FAX (303) 607-0767

CASTLE ROCK LIFELONG
LEARNING CENTER
CASTLE ROCK, COLORADO
OVERLOT GRADING AND
DRAINAGE PLAN

DATE: 1441801
SHEET NUMBER: 4

DATE: 9-13-00
DRAWN BY: NREL
CHECKED BY: JCC
APPROVED BY:

RED HAWK FILING NO. 1, THIRD AMENDMENT, LOTS 1 & 2 FINAL PD SITE PLAN
 A PARCEL OF LAND LOCATED IN THE EAST HALF OF SECTION 3, TOWNSHIP 8 SOUTH, RANGE 67 WEST, OF THE SIXTH PRINCIPAL MERIDIAN, TOWN OF CASTLE ROCK, COUNTY OF DOUGLAS, STATE OF COLORADO

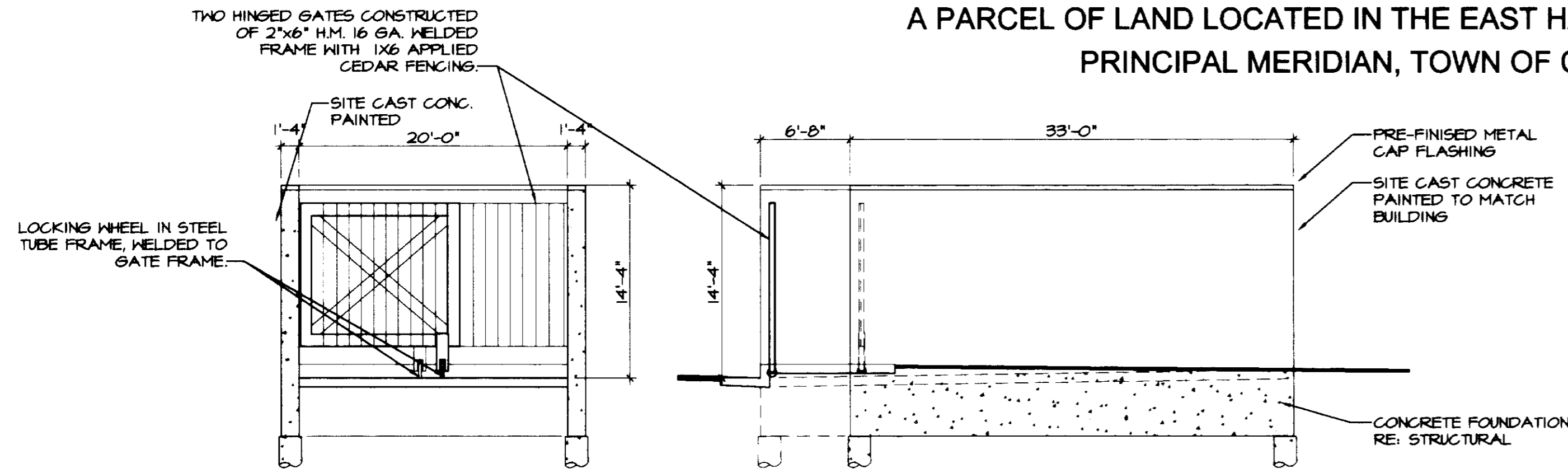
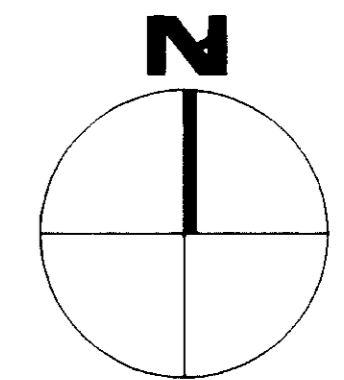

3 FRONT & SIDE ELEVATION @ TRASH ENCLOSURE

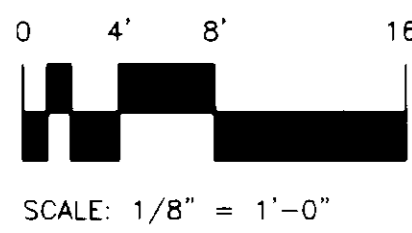

5 IDENTIFICATION SIGN PLAN

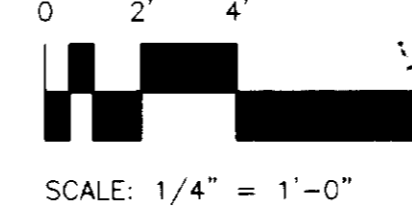

6 IDENTIFICATION SIGN ELEVATION

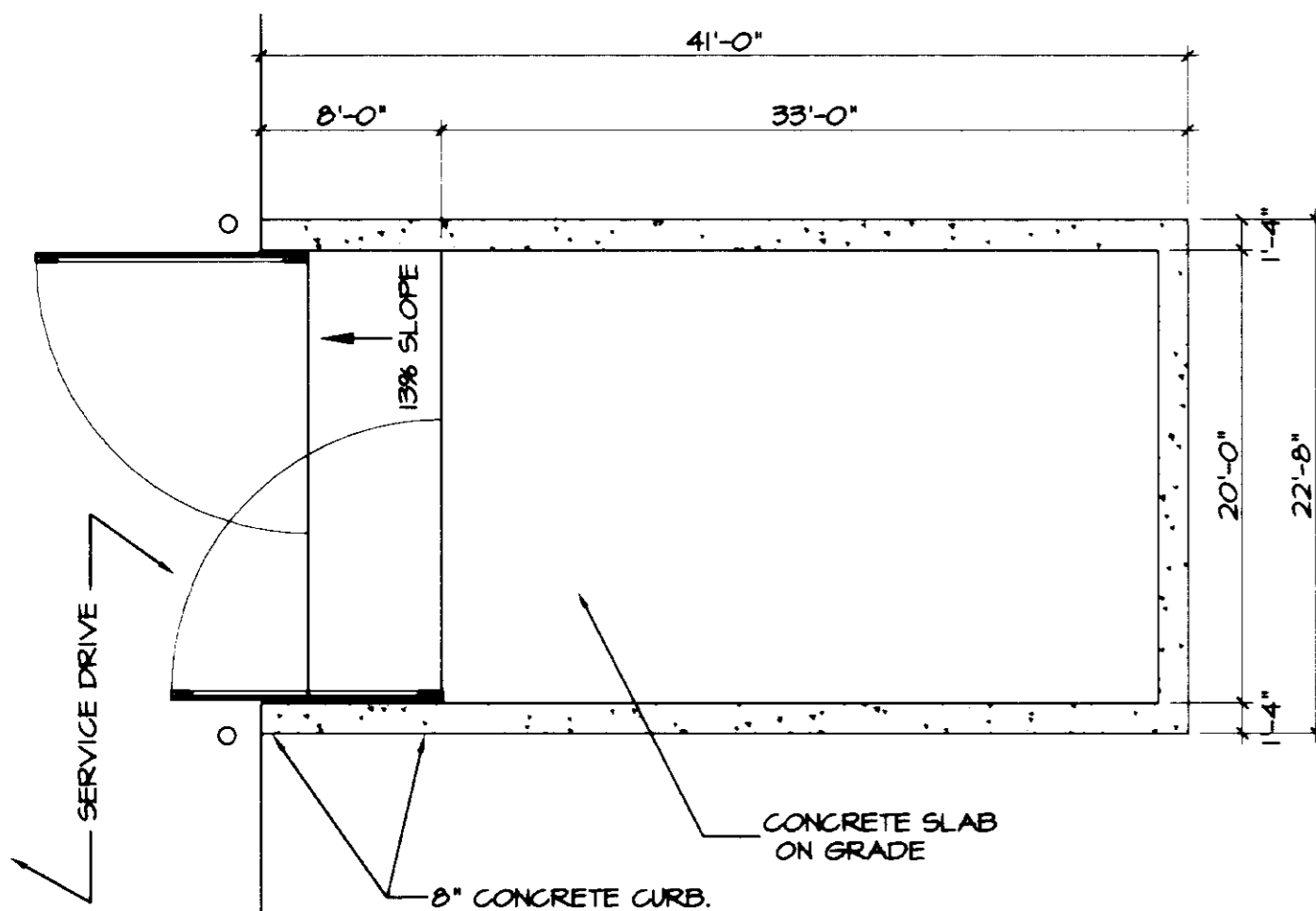
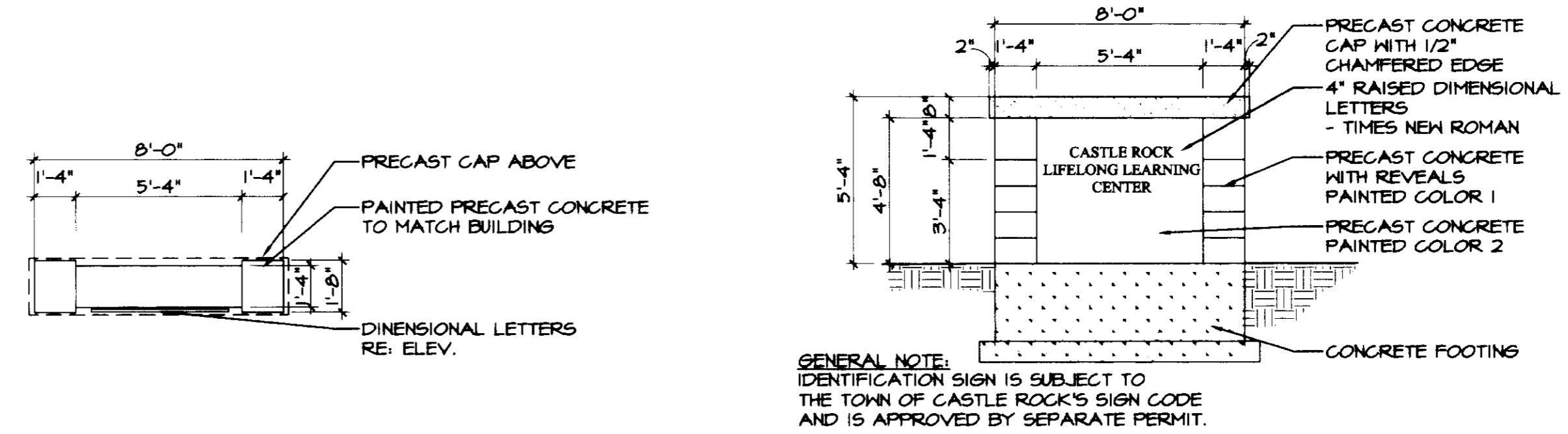
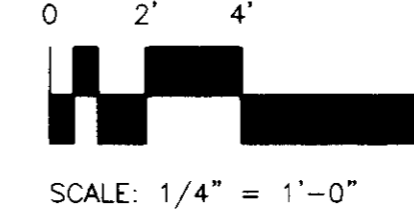

2 TRASH ENCLOSURE PLAN

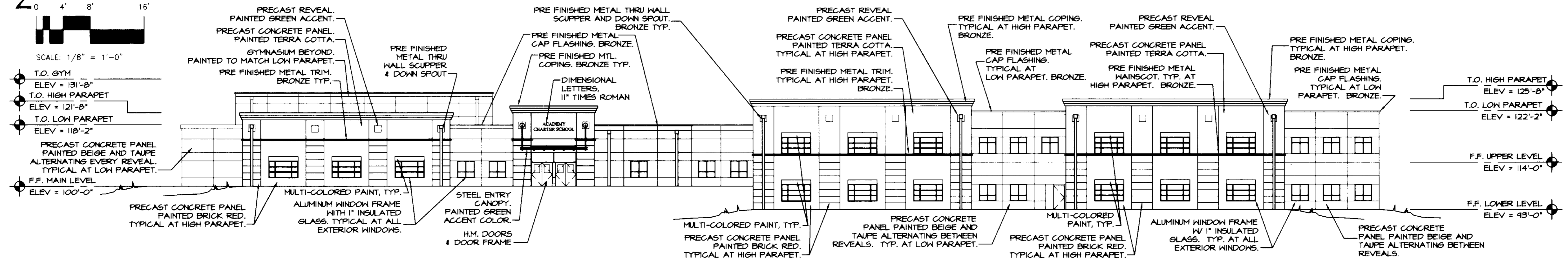
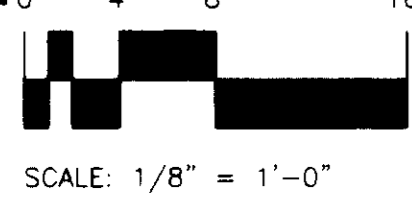

4 BUILDING ELEVATION EAST SIDE

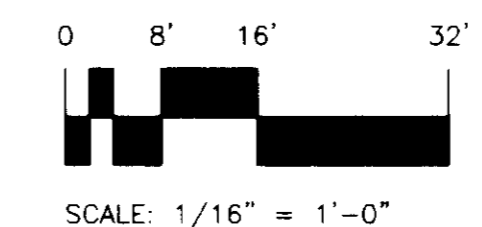

1 SOUTH ELEVATION AT ENTRY

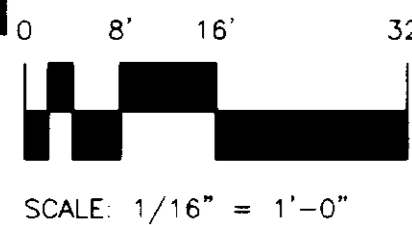

Unofficial Copy

**RED HAWK FILING NO. 1,
 THIRD AMENDMENT, LOTS 1 & 2
 CASTLE ROCK LIFELONG
 LEARNING CENTER
 FINAL PD SITE PLAN**

ISSUE
 RED HAWK FILING NO. 1
 THIRD AMENDMENT, LOTS 1 & 2
 CASTLE ROCK LIFELONG
 LEARNING CENTER
 FINAL SUBMITTAL
 FINAL PD
 FEB. 19, 2001

SLATER · PAULL & ASSOCIATES, INC.
 Architecture · Preservation · Interior Design
 ONE PARK CENTRAL, SUITE 400 1515 ARAPAHOE STREET
 DENVER, COLORADO 80202
 (303) 607-0977 FAX (303) 607-0767

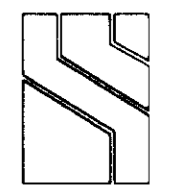

**CASTLE ROCK LIFELONG
 LEARNING CENTER
 CASTLE ROCK, COLORADO
 BUILDING, SIGN & TRASH
 ENCLOSURE ELEVATIONS**

JOB NUMBER:
 9945.030

6

SHEET NUMBER:

APPROVED BY: 2-15-01 DATE:

CHECKED BY: JKC

DRAWN BY: JKC

1999 05/25 v.d.s. cadwin_jr.ctb 14:35:05 2001

RED HAWK FILING NO. 1, THIRD AMENDMENT, LOTS 1 & 2 FINAL PD SITE PLAN

A PARCEL OF LAND LOCATED IN THE EAST HALF OF SECTION 3, TOWNSHIP 8 SOUTH, RANGE 67 WEST, OF THE SIXTH PRINCIPAL MERIDIAN, TOWN OF CASTLE ROCK, COUNTY OF DOUGLAS, STATE OF COLORADO

ISSUE
 RED HAWK FILING NO. 1
 THIRD AMENDMENT, LOTS 1 & 2
 CASTLE ROCK LIFELONG
 LEARNING CENTER
 FINAL SUBMITTAL
 FINAL PD
 FEB. 19, 2001

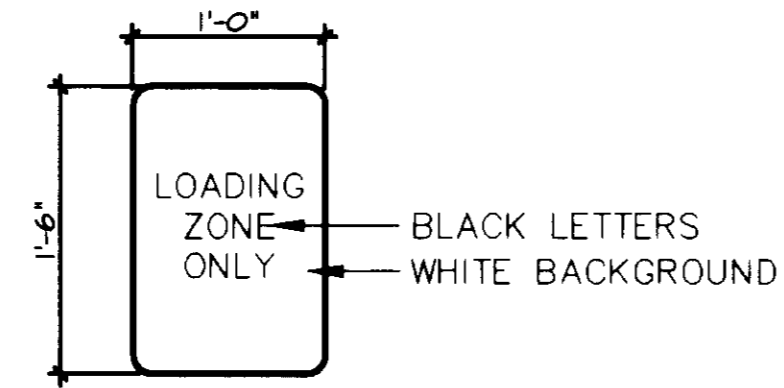

5 REQUIRED LOADING ZONE SIGN

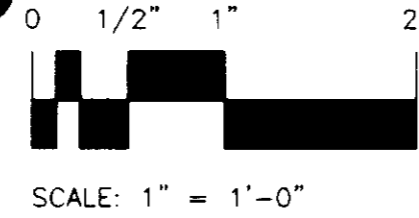

SCALE: 1" = 1'-0"

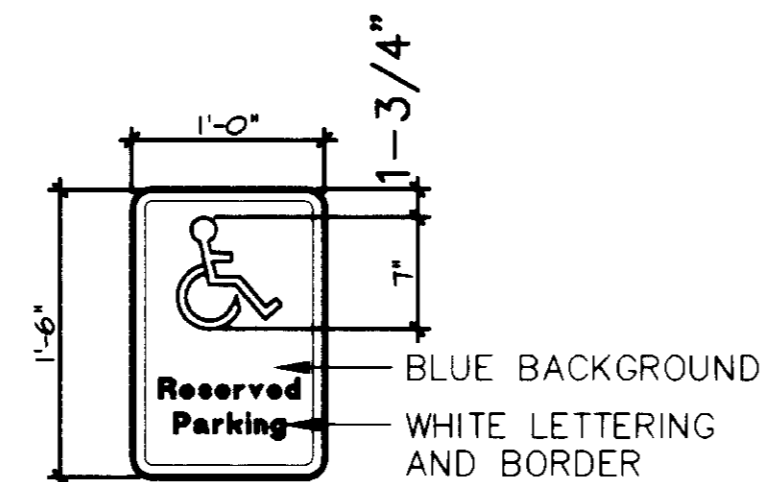

MOUNTING HEIGHT: 60" ABOVE THE FINISH FLOOR TO THE CENTERLINE OF THE SIGN

4 REQUIRED HC PARKING SIGN

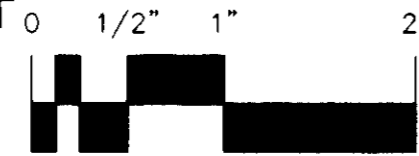

SCALE: 1" = 1'-0"

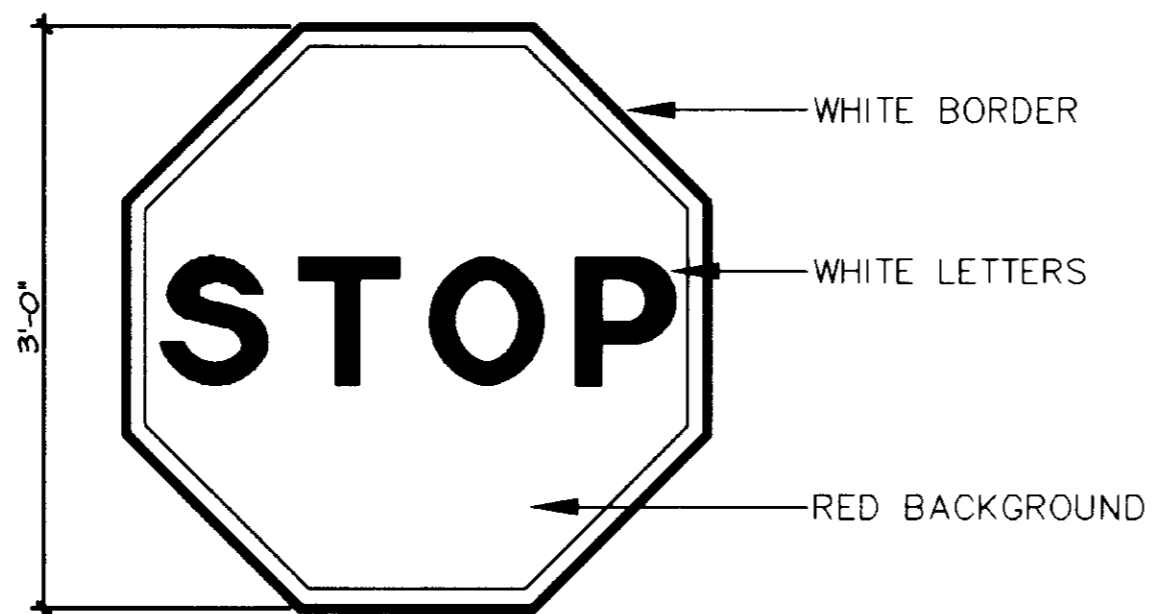

3 REQUIRED STOP SIGN ELEVATION

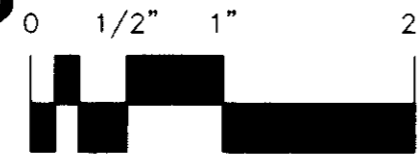

SCALE: 1" = 1'-0"

Unofficial Copy

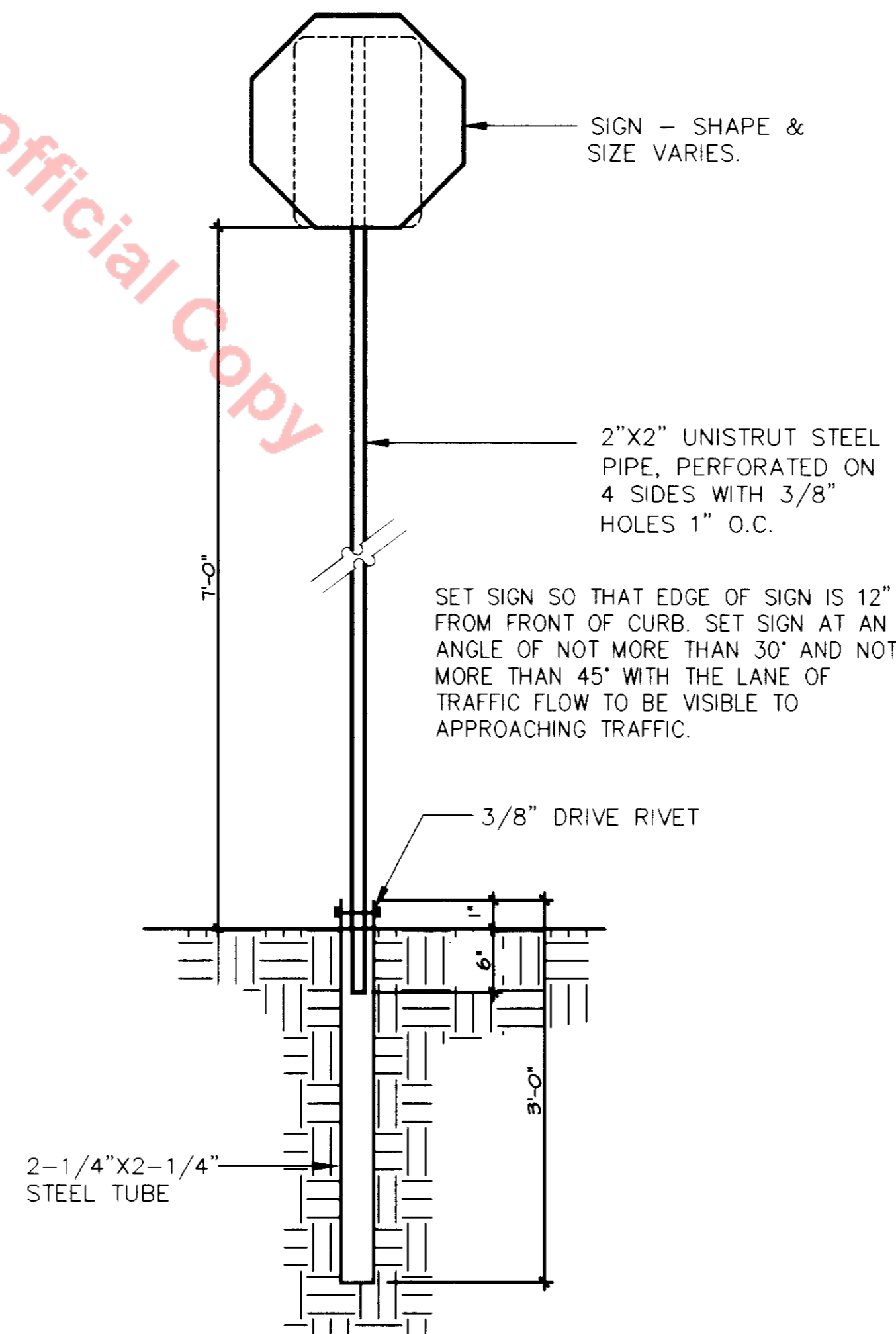

2 REQUIRED STOP SIGN SECTION

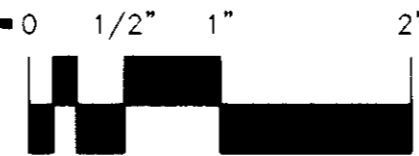

SCALE: 1" = 1'-0"

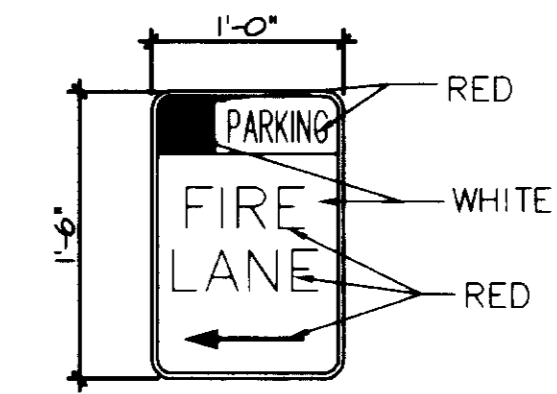
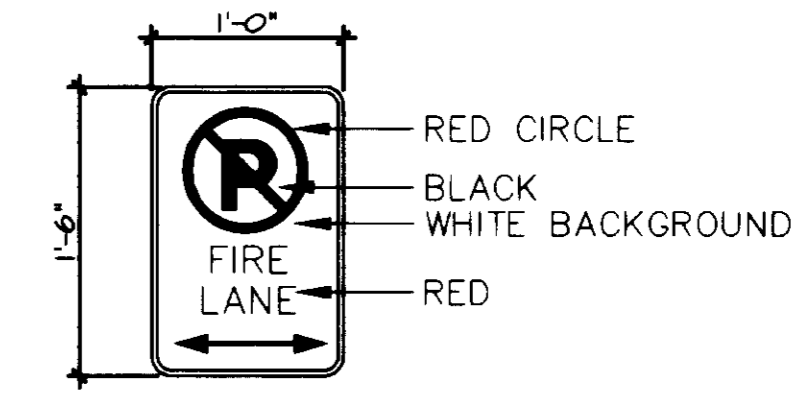

1 REQUIRED FIRE LANE SIGN

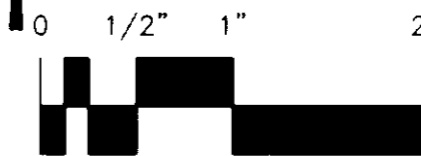

SCALE: 1" = 1'-0"

**RED HAWK FILING NO. 1,
 THIRD AMENDMENT, LOTS 1 & 2
 CASTLE ROCK LIFELONG
 LEARNING CENTER
 FINAL PD SITE PLAN**

SLATER · PAULL & ASSOCIATES, INC.
 Architecture · Preservation · Interior Design
 ONE PARK CENTRAL, SUITE 400 1515 ARAPAHOE STREET
 DENVER, COLORADO 80202
 (303) 607-0977 FAX (303) 607-0767

**CASTLE ROCK LIFELONG
 LEARNING CENTER
 CASTLE ROCK, COLORADO
 REQUIRED TRAFFIC SIGN
 ELEVATIONS**

JOB NUMBER:
 9945.030

7
 SHEET NUMBER:

DRAWN BY: APPROVED BY: 2-15-01 DATE

CHECKED BY: