

SITE DEVELOPMENT PLAN AMENDMENT NO. 1

LOT 5, BLOCK 6, PROMENADE AT CASTLE ROCK, FILING NO. 1, AMENDMENT NO. 6
 LOCATED IN THE NORTH 1/2 OF SECTION 27, TOWNSHIP 7 SOUTH, RANGE 67 WEST
 OF THE 6TH PRINCIPAL MERIDIAN COUNTY OF DOUGLAS, STATE OF COLORADO

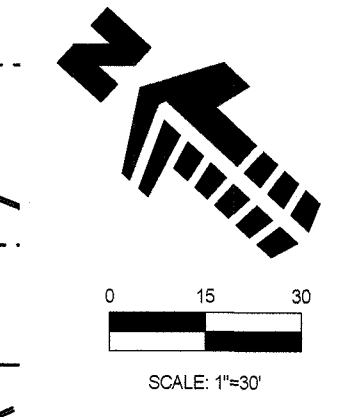
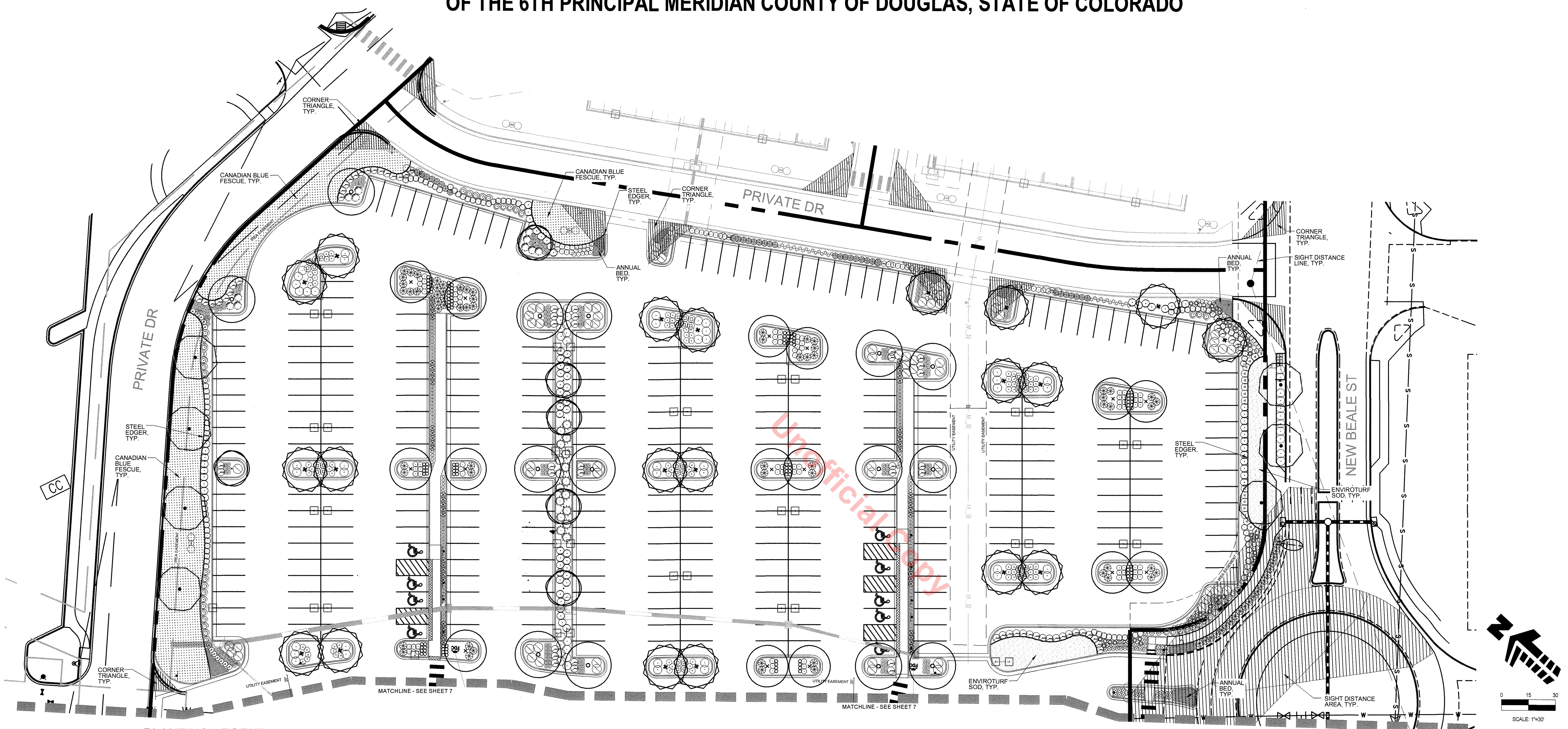
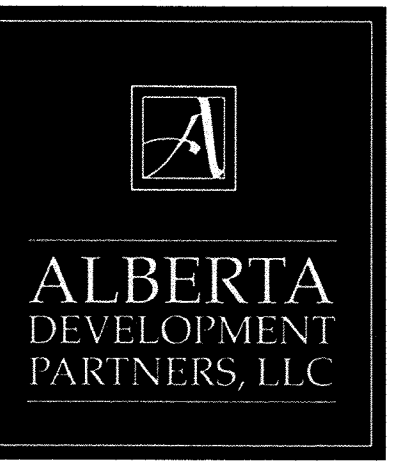

PLANTING LEGEND (BASED ON TOWN OF CASTLE ROCK LANDSCAPE MANUAL AND PROMENADES AT CASTLE ROCK FRAMEWORK DEVELOPMENT PLAN)

SYMBOL	LEGEND ABBREV.	BOTANIC NAME	COMMON NAME
OVERSTORY DECIDUOUS TREES			
●	ACFR	ACER X FREEMANII 'JEFFERSRED'	AUTUMN BLAZE MAPLE
●	CASP	CATALPA SPECIOSA	WESTERN CATALPA
●	CECC	CELTIS OCCIDENTALIS	WESTERN HACKBERRY
●	GLTR	GLIEDISIA TRIACANTHOS INERMIS SKYLINE	SHADEMASTER LOCUST
●	SOJA	SOPHORA JAPONICA	JAPANESE PAGODA TREE
EVERGREEN TREES			
●	PIPO	PINUS PONDEROSA	PONDEROSA PINE
ORNAMENTAL DECIDUOUS TREES			
●	AMGR	AMERLANCHIER X GRANDIFLORA 'AUTUMN BRILLIANCE'	AUTUMN BRILLIANCE SERVICEBERRY
DECIDUOUS SHRUBS			
●	CACL	CARYOPTERIS X CLANDONENSIS	BLUE MIST SPIREA
●	CHMI	CHAMAEBATIARA MILLEFOLIUM	FERNBUSH
●	CHNA	CHRYSOTHAMNUS NAUSEOSUS	RABBITBRUSH
●	FAPA	FALLUGIA PARADOXA	APACHE PLUME
●	FONE	FORESTIERA NEOMEXICANA	NEW MEXICO PRIVET
●	LIVU	LIGUSTRUM VULGARE 'LODENSE'	LODENSE PRIVET
●	PEAT	PEROVSKIA ATRIPLICIFOLIA	RUSSIAN SAGE
●	PHOP	PHYSOCARPUS OPUULIFOLIUS 'DONNA MAY'	LITTLE DEVIL NINEBARK
●	PRBW	PRUNUS BESSEYI 'WESTERN'	WESTERN SAND CHERRY
●	RHAR	RHUS AROMATICA 'GRO-LOW'	GRO-LOW SUMAC
●	RHGL	RHUS GLABRA 'CISMONTANA'	ROCKY MOUNTAIN SUMAC
●	RIAL	RIBES ALPINUM	ALPINE CURRANT
●	RORA	ROSA 'RAD SUNNY'	SUNNY KNOCK OUT ROSE
EVERGREEN SHRUBS			
●	ARCO	ARCTOSTAPHYLOS X COLORADENSIS 'CHIEFTAIN'	CHIEFTAIN MAZANITA
●	ARCP	ARCTOSTAPHYLOS X COLORADENSIS 'PANCHITO'	PANCHITO MAZANITA
●	JUHO	JUNIPERUS HORIZONTALIS 'BLUE CHIP'	BLUE CHIP JUNIPER
●	JUPC	JUNIPERUS X MEDIA 'PITZERANA COMPACT'	PITZER COMPACT JUNIPER
●	PIMU	PINUS MUGO 'SLOWMOUND'	SLOWMOUND MUGO PINE
ORNAMENTAL GRASSES			
●	ANGE	ANDROPOGON GERARDII	BIG BLUESTEM
●	CAAC	CALAMAGROSTIS ACUTIFLORA 'KARL FOERSTER'	FEATHER REED GRASS
●	HESE	HELICTOTRICHON SEMPERVIRENS	BLUE AVENA GRASS
●	MISI	MISCANTHUS SINENSIS	MAIDEN GRASS
●	NATE	NASSELLA TENUISSIMA	MEXICAN FEATHER GRASS
●	PAVI	PANICUM VIRGATUM 'SHANADOAH'	RED SWITCH GRASS
●	PEOR	PENNESETUM ORIENTALE 'KARLEY ROSE'	KARLEY ROSE FOUNTAIN GRASS
●	SCSC	SCHIZACHYRIUM SCOPARIUM	LITTLE BLUESTEM
PERENNIALS			
●	CAIN	CALLIRHOE INVOLUCRATA	PRAIRIE WINECUMPS
●	CETO	CERASTIUM TOMENTOSUM	SNOW-IN-SUMMER
●	KNUV	KNIPOFIA UVARIA	TORCH LILY
●	SESP	SEDUM SPECTABILE 'AUTUMN JOY'	AUTUMN JOY SEDUM
SEED & MULCH			
■	TURF	ENVIROTURF SOD, SEE SOD NOTES, THIS SHEET	ENVIROTURF SOD
■	TURF	CANADIAN BLUE FESCUE GRASS, SEE LANDSCAPE NOTES	CANADIAN BLUE FESCUE GRASS
■	SEED	IRRIGATED DRYLAND SEED / WILDFLOWER MIX, SEE SEED NOTES	GRASS SEED
■	MULCH	4" #2 DIA. MULTI-COLOR COBBLE ROCK MULCH WITH DOUBLE SHREDDED BARK MULCH, SEE LANDSCAPE NOTES	ROCK MULCH

6 LANDSCAPE PLAN
 SCALE: 1" = 30'

#	Date	Issue / Description
-	09/02/2016	SDP SUBMITTAL
-	10/07/2016	SDP RESUBMITTAL
-	12/20/2016	SDP RESUBMITTAL
-	01/05/2017	MYLAR RESUBMITTAL
-	08/08/2018	SDP AMENDMENT #6

Project No: _____
 Drawn By: _____ NLR
 Checked By: _____ TTN
 Date: _____ 12/20/2016
 Disk File: _____

SHEET TITLE:
 LANDSCAPE PLAN

TOWN OF CASTLE ROCK REGISTRATION INFORMATION:
 CERTIFIED LANDSCAPE ARCHITECT
 TOWN OF CASTLE ROCK REGISTRATION NUMBER #18-1994
 LICENSED LANDSCAPE ARCHITECT STATE OF COLORADO LA-122

TM NELSON
 #18-1994
 LA-122

SDP18-0022 SITE DEVELOPMENT PLAN AMENDMENT NO. 1
 LOT 5, BLOCK 6, PROMENADE AT CASTLE ROCK, FILING NO. 1, AMENDMENT NO. 6



SITE DEVELOPMENT PLAN AMENDMENT NO. 1

LOT 5, BLOCK 6, PROMENADE AT CASTLE ROCK, FILING NO. 1, AMENDMENT NO. 6
 LOCATED IN THE NORTH 1/2 OF SECTION 27, TOWNSHIP 7 SOUTH, RANGE 67 WEST
 OF THE 6TH PRINCIPAL MERIDIAN COUNTY OF DOUGLAS, STATE OF COLORADO

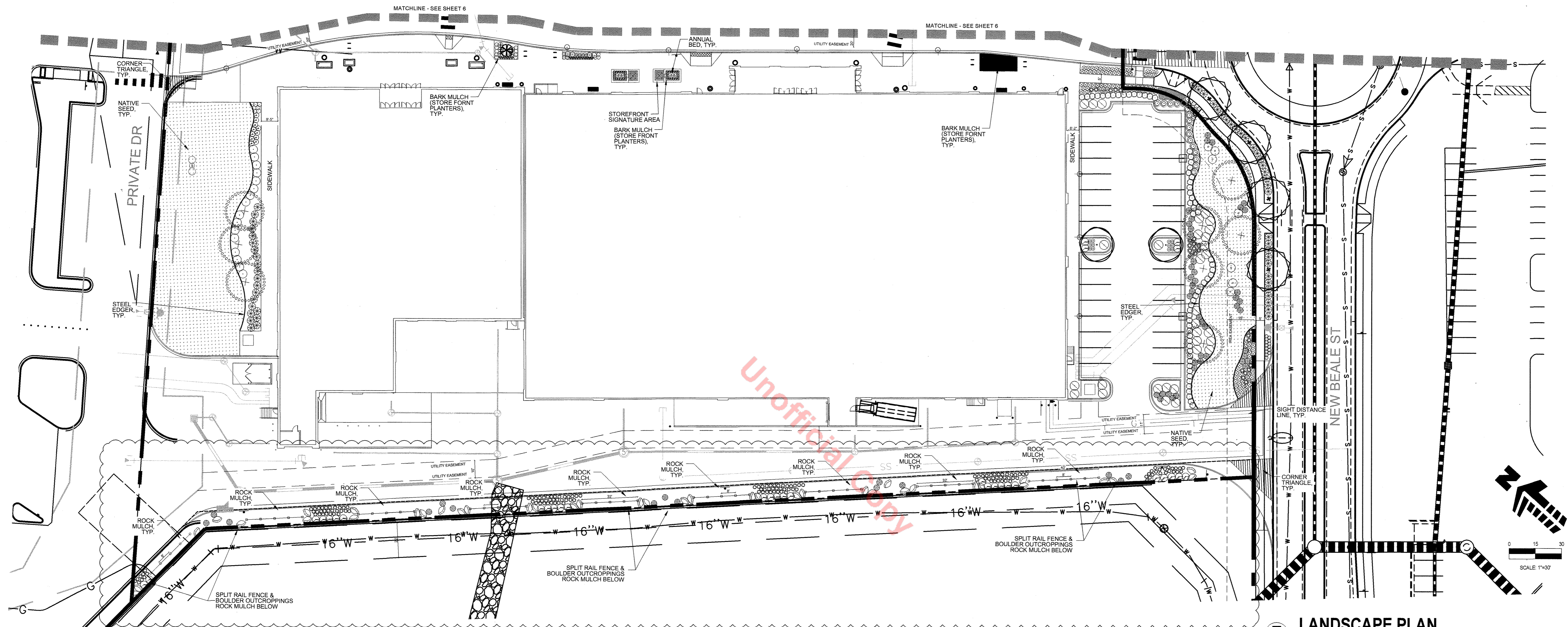
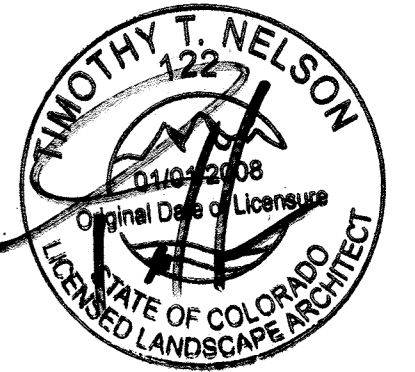
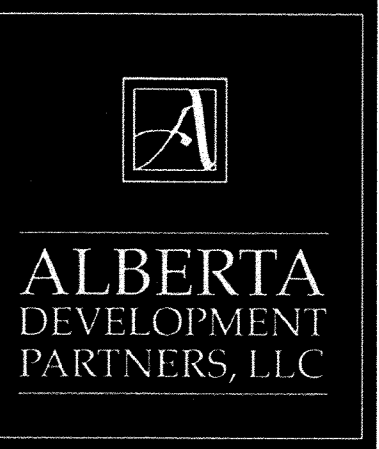

7 LANDSCAPE PLAN
 SCALE: 1" = 30'

PLANTING LEGEND (BASED ON TOWN OF CASTLE ROCK LANDSCAPE MANUAL AND PROMENADES AT CASTLE ROCK FRAMEWORK DEVELOPMENT PLAN)

SYMBOL	LEGEND ABBREV.	BOTANIC NAME	COMMON NAME	SYMBOL	LEGEND ABBREV.	BOTANIC NAME	COMMON NAME
OVERSTORY DECIDUOUS TREES							
ACFR	ACFR	ACER X FREEMANII 'JEFFERSRED'	AUTUMN BLAZE MAPLE	ARCO	ARCTOSTAPHYLOS X COLORADENSIS 'CHIEFTAIN'	CHIEFTAIN MAZANITA	
CASP	CASP	CATALPA SPECIOSA	WESTERN CATALPA	ARCP	ARCTOSTAPHYLOS X COLORADENSIS 'PANCHITO'	PANCHITO MANZANITA	
CEOC	CEOC	CELTIS OCCIDENTALIS	WESTERN HACKBERRY	JUHO	JUNIPERUS HORIZONTALIS 'BLUE CHIP'	BLUE CHIP JUNIPER	
GLTR	GLTR	GLEDITSIA TRIACANTHOS INERMIS	SHADEMASTER LOCUST	JJPC	JUNIPERUS X MEDIA 'PFITZER COMPACT'	PFITZER COMPACT JUNIPER	
SOJA	SOJA	SOPHORA JAPONICA	JAPANESE PAGODA TREE	PMU	PINUS MUGO 'SLOWMOUND'	SLOWMOUND MUGO PINE	
EVERGREEN TREES							
PIPO	PIPO	PINUS PONDEROSA	PONDEROSA PINE	ORNAMENTAL GRASSES			
ORNAMENTAL DECIDUOUS TREES							
AMGR	AMGR	AMERLANCHIER X GRANDIFLORA 'AUTUMN BRILLIANCE'	AUTUMN BRILLIANCE SERVICEBERRY	ANGE	ANDROPOGON GERARDII	BIG BLUESTEM	
DECIDUOUS SHRUBS							
CACL	CACL	CARYOPTERIS X CLANDONENSIS	BLUE MIST SPIREA	CAAC	CALAMAGROSTIS ACUTIFLORA 'KARL FOERSTER'	FEATHER REED GRASS	
CHMI	CHMI	CHAMAEBATIARA MILLEFOLIUM	FERNBUSH	HISE	HELICTOTRICHON SEMPERVIRENS	BLUE AVENA GRASS	
CHNA	CHNA	CHRYSOTHAMNUS NAUSEOSUS	RABBITBRUSH	MISI	MISCANTHUS SINENSIS	MAIDEN GRASS	
FAPA	FAPA	FALLUGIA PARADOXA	APACHE PLUME	NATE	NASSELLA TENUISSIMA	MEXICAN FEATHER GRASS	
FONE	FONE	FORESTIERA NEOMEXICANA	NEW MEXICO PRIVET	PAVI	PANICUM VIRGATUM 'SHANADOAH'	RED SWITCH GRASS	
LIVU	LIVU	LIGUSTRUM VULGARE 'LODENSE'	LODENSE PRIVET	PEOR	PENICISE TUM ORIENTALE 'KARLEY ROSE'	KARLEY ROSE FOUNTAIN GRASS	
PEAT	PEAT	PEROVSKIA ATRIPLICIFOLIA	RUSSIAN SAGE	SCSC	SCHIZACHYRIUM SCOPARIUM	LITTLE BLUESTEM	
PHOP	PHOP	PHYSOCARPUS OPULIFOLIUS	LITTLE DEVIL NINEBARK	PERENNIALS			
PRBW	PRBW	PRUNUS BESSEYI 'WESTERN'	WESTERN SAND CHERRY	CAIN	CALLIRHOE INVOLUCRATA	PRAIRIE WINECUPS	
RHAR	RHAR	RHUS AROMATICA 'GRO-LOW'	GRO-LOW SUMAC	CETO	CERASTIUM TOMENTOSUM	SNOW-IN-SUMMER	
RHGL	RHGL	RHUS GLABRA 'CISMONTANA'	ROCKY MOUNTAIN SUMAC	KNUV	KNIPOFIA UVARIA	TORCH LILY	
RIAL	RIAL	RIBES ALPNUM	ALPINE CURRANT	SESP	SEDUM SPECTABILE 'AUTUMN JOY'	AUTUMN JOY SEDUM	
RORA	RORA	ROSA 'RADSYUNNY'	SUNNY KNOCK OUT ROSE	SEED & MULCH			
				TURF	ENVIROTURF SOD, SEE SOD NOTES, THIS SHEET	ENVIROTURF SOD	
				TURF	CANADIAN BLUE FESCUE GRASS, SEE LANDSCAPE NOTES	CANADIAN BLUE FESCUE GRASS	
				SEED	IRRIGATED DRYLAND SEED / WILDFLOWER MIX, SEE SEED NOTES	GRASS SEED	
				MULCH	4" - 6" DIA. MULTI-COLOR COBBLE ROCK MULCH WITH DOUBLE SHREDDED BARK MULCH, SEE LANDSCAPE NOTES	ROCK MULCH	
				BOULDER	VARYING IN SHAPES, 3" X 4" QUANTITY >= 38 BOULDERS		

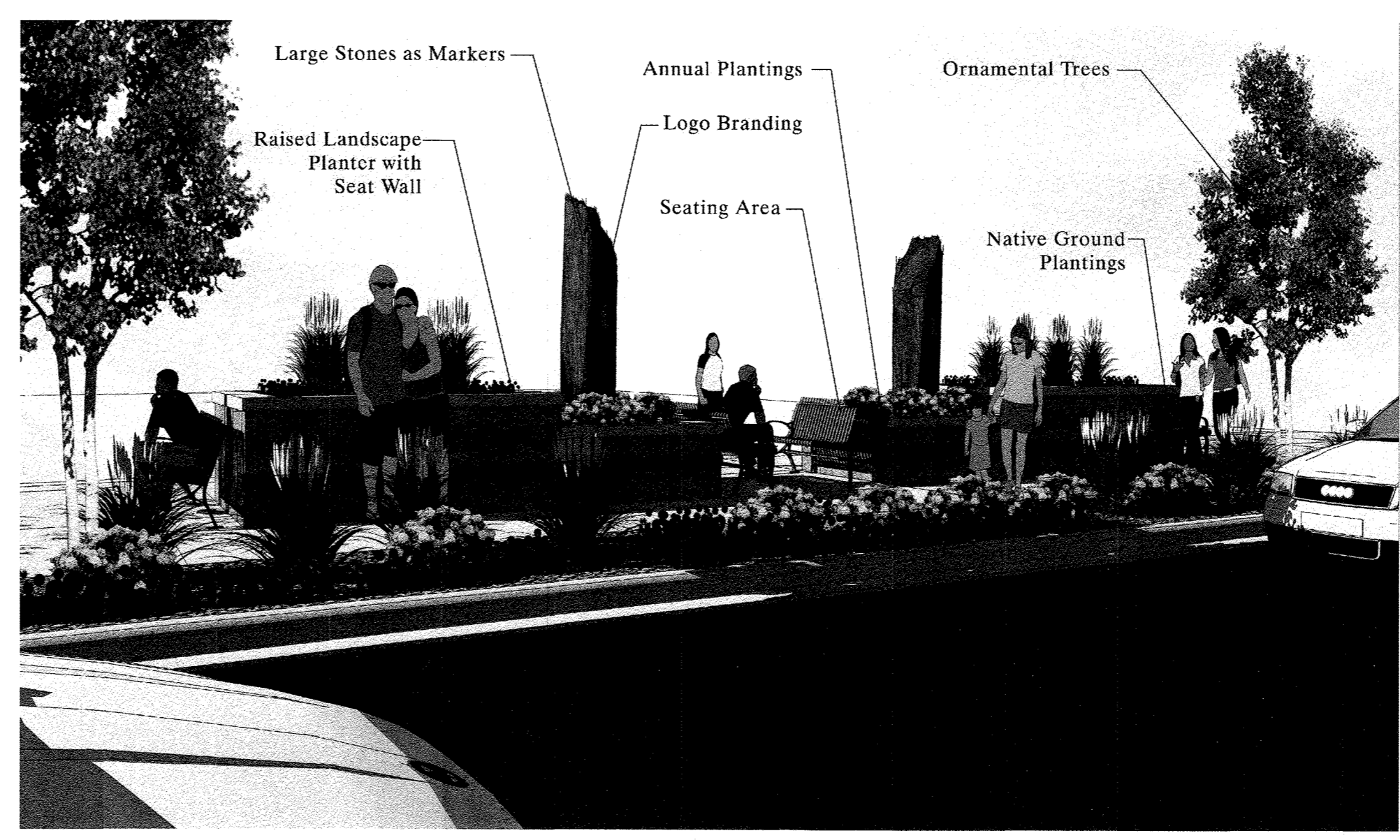

1 CONCEPTUAL STOREFRONT SIGNATURE AREA
 SCALE: NOT TO SCALE

TOWN OF CASTLE ROCK REGISTRATION INFORMATION:
 CERTIFIED LANDSCAPE ARCHITECT
 TOWN OF CASTLE ROCK REGISTRATION NUMBER #18-1994
 LICENSED LANDSCAPE ARCHITECT STATE OF COLORADO LA-122

SDP18-0022 SITE DEVELOPMENT PLAN AMENDMENT NO. 1
LOT 5, BLOCK 6, PROMENADE AT CASTLE ROCK, FILING
NO. 1, AMENDMENT NO. 6

#	Date	Issue / Description
-	09/02/2016	SDP SUBMITTAL
-	10/07/2016	SDP RESUBMITTAL
-	12/20/2016	SDP RESUBMITTAL
-	01/05/2017	MYLAR RESUBMITTAL
-	08/09/2018	SDP AMENDMENT #6

Project No: _____
 Drawn By: _____
 Checked By: _____
 Date: _____
 Disk File: _____

SHEET TITLE:
 LANDSCAPE PLAN



