

PLAT IDENTIFICATION SHEET

Reception #: 8721829

Number of pages: 3

Date: 07/24/87

Name: MEADOWS

MISCELLANEOUS COMMENTS:

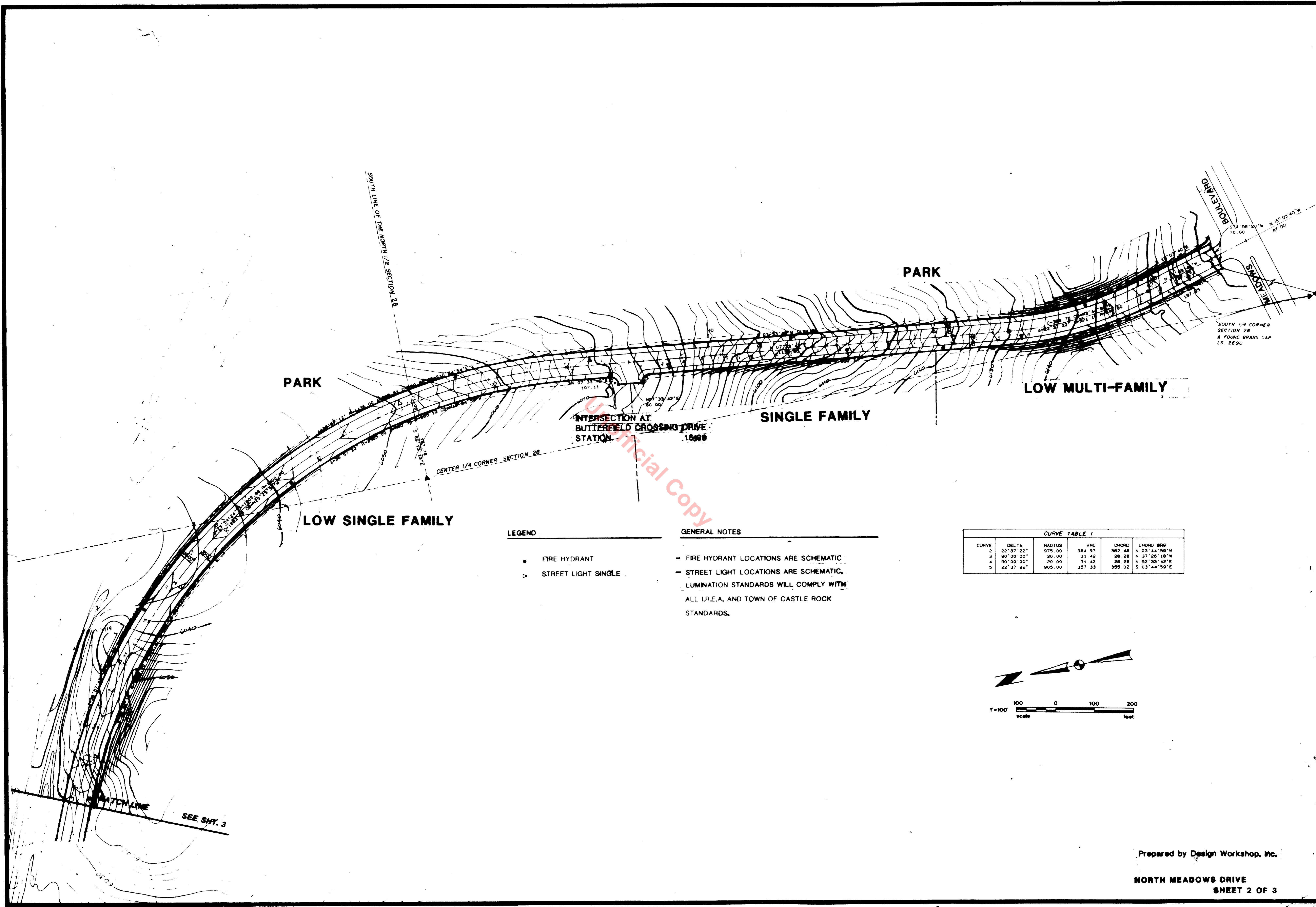

LEGEND

- FIRE HYDRANT
- ▷ STREET LIGHT SINGLE

GENERAL NOTES

- FIRE HYDRANT LOCATIONS ARE SCHEMATIC
- STREET LIGHT LOCATIONS ARE SCHEMATIC
- LUMINATION STANDARDS WILL COMPLY WITH ALL I.R.E.A. AND TOWN OF CASTLE ROCK STANDARDS.

CURVE TABLE I

CURVE	DELTA	RADIUS	ARC	CHORD	CHORD BRG
2	22° 37' 22"	975.00	384.97	382.48	N 03° 44' 59" W
3	90° 00' 00"	20.00	31.42	28.28	N 37° 26' 18" W
4	90° 00' 00"	20.00	31.42	28.28	N 52° 33' 42" E
5	22° 37' 22"	905.00	357.33	355.02	S 03° 44' 59" E

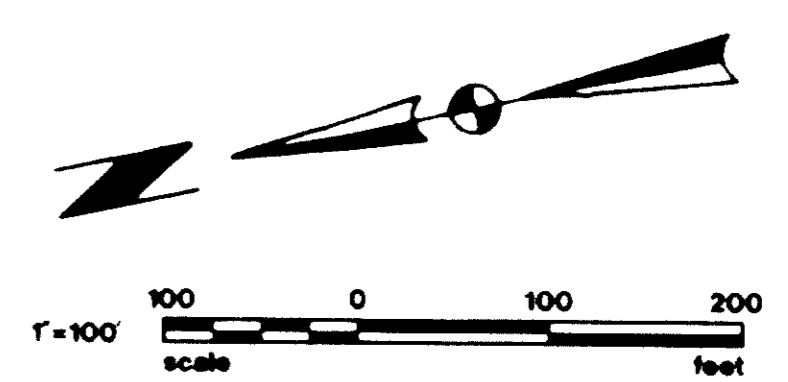

Prepared by Design Workshop, Inc.

**NORTH MEADOWS DRIVE
SHEET 2 OF 3**

NW CORNER
SECTION 28
A TOWN BRASS CAP
L.S. 7134

300° 20' 00" W
70.18

LINE OF THE
SECTION

6010

LOW SINGLE FAMILY

6015

6020

SECTION 2
MATCHLINE

6010

