

SITE DEVELOPMENT PLAN AMENDMENT NO. 1

LOTS 4 - 9, CASTLE PINES COMMERCIAL FILING NO. 10A, AMENDMENT NO. 1

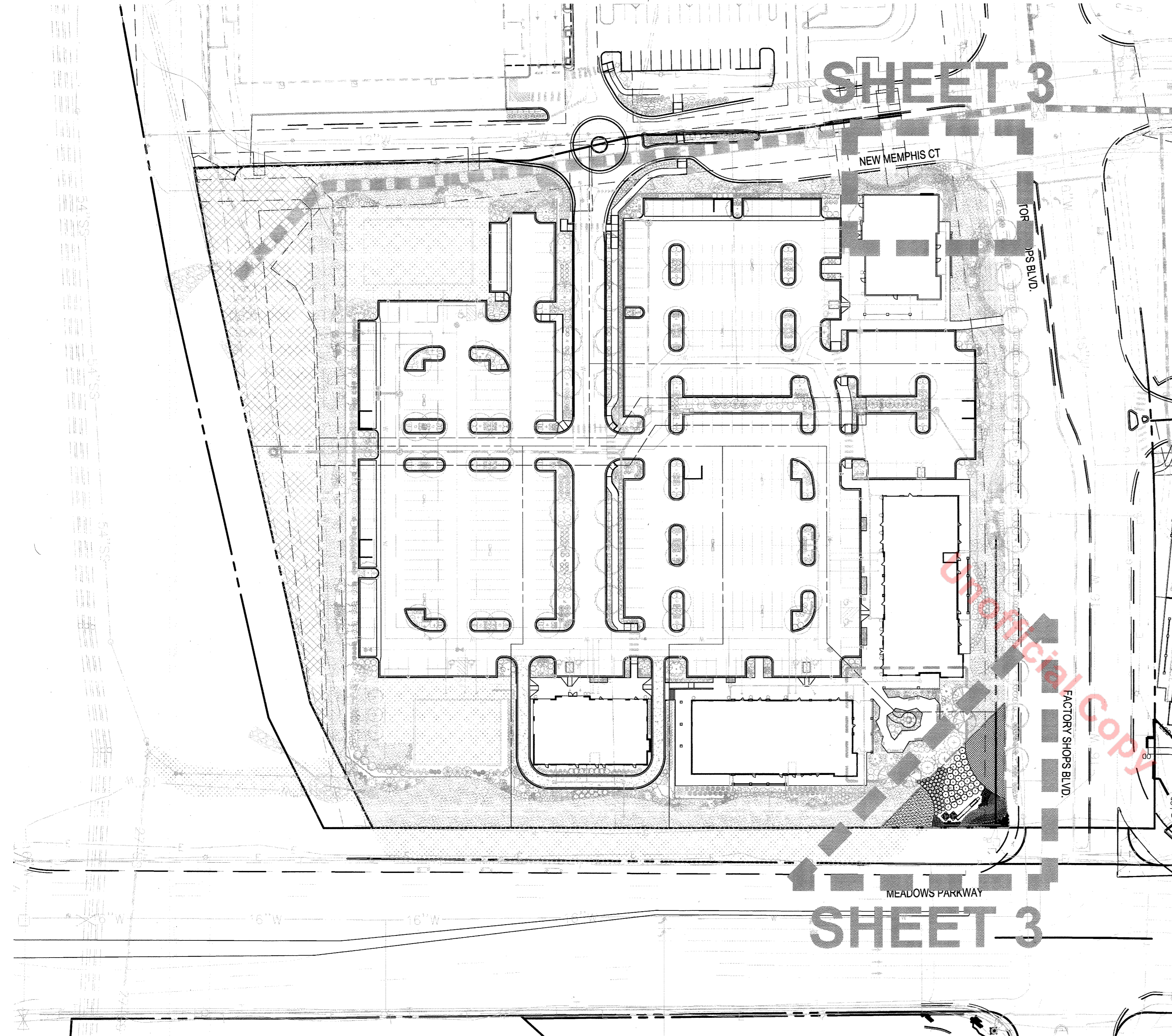
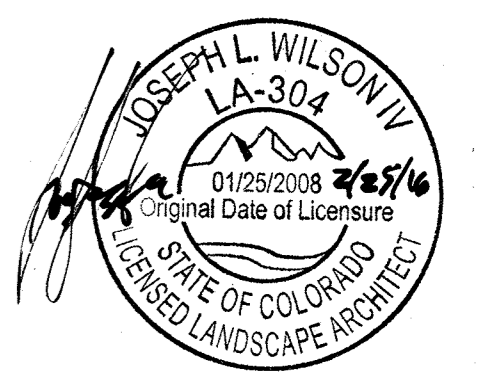
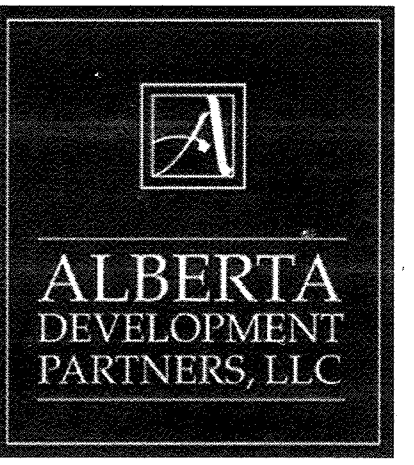

PLANTING NOTES

GENERAL

- CALL UNCC AT (303) 232-1991 PRIOR TO ANY EXCAVATION.
- ALL WORK SHALL CONFORM TO ALL APPLICABLE STATE AND LOCAL CODES, STANDARDS, AND SPECIFICATIONS.
- LANDSCAPE DESIGN IS DIAGRAMMATIC IN NATURE. THE CONTRACTOR SHALL BE RESPONSIBLE FOR HIS OWN TAKEOFFS AND QUANTITY CALCULATIONS. IN THE EVENT OF A DISCREPANCY BETWEEN THE PLAN AND THE LANDSCAPE LEGEND, THE PLANT QUANTITY AS SHOWN ON THE PLAN SHALL TAKE PRECEDENCE AND NOTIFY THE LANDSCAPE ARCHITECT OF THESE DISCREPANCIES. MINOR ADJUSTMENTS TO THE LANDSCAPE MATERIAL AND LOCATIONS MAY BE PROPOSED FOR TOWN CONSIDERATION AT THE CONSTRUCTION DOCUMENT STAGE TO RESPOND TO MARKET AND FIELD CONDITIONS. HOWEVER, THERE SHALL BE NO REDUCTION IN THE NUMBER AND SIZE OF MATERIALS.
- THE CONTRACTOR SHALL MAKE HIMSELF AWARE OF THE LOCATIONS OF EXISTING AND PROPOSED UTILITIES, AND SHALL BE RESPONSIBLE FOR ANY DAMAGE TO THE UTILITIES AND/OR ANY INJURY TO ANY PERSON.
- ALL UTILITY EASEMENTS SHALL REMAIN UNOBTSTRUCTED AND FULLY ACCESSIBLE ALONG THEIR ENTIRE LENGTH FOR MAINTENANCE EQUIPMENT.
- THE CONTRACTOR SHALL TAKE EXTREME CARE NOT TO DAMAGE ANY EXISTING PLANTS INDICATED AS "TO REMAIN". ANY SUCH PLANTS DAMAGED BY THE CONTRACTOR SHALL BE REPLACED WITH THE SAME SPECIES, SIZE, AND QUANTITY AT THE CONTRACTOR'S OWN EXPENSE, AND AS ACCEPTABLE TO THE OWNER. REFER TO THE TREE PROTECTION NOTES ON THE PLANS (AS APPLICABLE).
- LANDSCAPE CONTRACTOR SHALL EXAMINE THE SITE CONDITIONS UNDER WHICH THE WORK IS TO BE PERFORMED AND NOTIFY THE GENERAL CONTRACTOR IN WRITING OF UNSATISFACTORY CONDITIONS. IF SITE CONDITIONS OR PLANT AVAILABILITY REQUIRE CHANGES TO THE PLAN, THEN AN APPROVAL WILL BE OBTAINED FROM THE TOWN. DO NOT PROCEED UNTIL CONDITIONS HAVE BEEN CORRECTED.
- ALL CONSTRUCTION DEBRIS AND MATERIAL SHALL BE REMOVED AND CLEANED OUT PRIOR TO INSTALLATION OF TOPSOIL, TREES, SHRUBS, AND TURF.
- FOR ALL INFORMATION ON SURFACE MATERIAL OF WALKS, DRIVES, AND PARKING LOTS, SEE THE SITE PLAN. SEE GRADING PLANS FOR EXISTING AND PROPOSED SLOPE CONDITIONS. SEE PHOTOMETRIC PLAN FOR FREE STANDING LIGHTING INFORMATION.
- ALL LANDSCAPE NOTES SHALL BE COORDINATED WITH ALL APPLICABLE SPECIFICATION SECTIONS. ANY DISCREPANCY SHALL BE BROUGHT TO THE ATTENTION OF THE GENERAL CONTRACTOR AND LANDSCAPE ARCHITECT BEFORE PROCEEDING WITH WORK.
- THE LANDSCAPE CONTRACTOR SHALL NOTIFY THE LANDSCAPE ARCHITECT ONE WEEK PRIOR TO BEGINNING CONSTRUCTION.
- WINTER WATERING SHALL BE AT THE EXPENSE OF THE CONTRACTOR UNTIL SUCH TIME AS FINAL ACCEPTANCE IS RECEIVED.
- ALL LANDSCAPE CONSTRUCTION PRACTICES, WORKMANSHIP, AND ETHICS SHALL BE IN ACCORDANCE WITH INDUSTRY STANDARDS SET FORTH IN THE CONTRACTOR'S HANDBOOK PUBLISHED BY THE COLORADO LANDSCAPE CONTRACTORS ASSOCIATION.
- LANDSCAPE AND IRRIGATION WORK SHALL BE COMPLETED PRIOR TO THE ISSUANCE OF THE FINAL CERTIFICATE OF OCCUPANCY.

FINISH GRADING AND SOIL PREPARATION

- CONTRACTOR SHALL CONSTRUCT AND MAINTAIN FINISH GRADES AS RECOMMENDED BY THE GEOTECHNICAL REPORT. ALL LANDSCAPE AREAS SHALL HAVE POSITIVE DRAINAGE AWAY FROM STRUCTURES AT THE MINIMUM SLOPE SPECIFIED IN THE REPORT, AND AREAS OF POTENTIAL PONDING SHALL BE REGRADED TO BLEND IN WITH THE SURROUNDING GRADES AND ELIMINATE PONDING POTENTIAL. SHOULD ANY CONFLICTS AND/OR DISCREPANCIES ARISE BETWEEN THE GEOTECHNICAL REPORT, THE GRADING PLANS, THESE NOTES, AND ACTUAL CONDITIONS, THE CONTRACTOR SHALL IMMEDIATELY BRING SUCH ITEMS TO THE ATTENTION OF THE LANDSCAPE ARCHITECT AND OWNER.
- AFTER FINISH GRADES HAVE BEEN ESTABLISHED, IT IS RECOMMENDED THAT THE CONTRACTOR SHALL HAVE SOIL SAMPLES TESTED BY AN ESTABLISHED SOIL TESTING LABORATORY FOR THE FOLLOWING: GENERAL SOIL FERTILITY, PH, ORGANIC MATTER CONTENT, SALT (GEO), LIME, SODIUM ADSORPTION RATIO (SAR) AND BORON CONTENT. EACH SAMPLE SUBMITTED SHALL CONTAIN NO LESS THAN ONE QUART OF SOIL. CONTRACTOR SHALL ALSO SUBMIT THE PROJECT'S PLANT LIST TO THE LABORATORY ALONG WITH THE SOIL SAMPLES. THE SOIL REPORT PRODUCED BY THE LABORATORY SHALL CONTAIN RECOMMENDATIONS FOR THE FOLLOWING (AS APPROPRIATE): GENERAL SOIL PREPARATION AND BACKFILL MIXES; PRE-PLANT FERTILIZER APPLICATIONS, AND ANY OTHER SOIL RELATED ISSUES. THE REPORT SHALL ALSO PROVIDE A FERTILIZER PROGRAM FOR THE ESTABLISHMENT PERIOD AND FOR LONG-TERM MAINTENANCE.
- THE CONTRACTOR SHALL RECOMMEND INSTALLATION OF SOIL AMENDMENTS AND FERTILIZERS PER THE SOILS REPORT FOR THE OWNER'S REPRESENTATIVE CONSIDERATION.
- AT A MINIMUM, ALL TOPSOIL SHALL BE AMENDED WITH THE FOLLOWING: NITROGEN STABILIZED ORGANIC AMENDMENT COMPOST AT A RATE OF 4.0 CUBIC YARDS PER THOUSAND SQUARE FEET. CONTRACTOR TO CONTACT THE TOWN OF CASTLE ROCK UTILITY DEPARTMENT FOR A SOIL INSPECTION BEFORE INSTALLATION OF PLANT MATERIAL. AMMONIUM PHOSPHATE 16-20-0 AT A RATE OF 15 POUNDS PER THOUSAND SQUARE FEET.
- COMPOST SHALL BE MECHANICALLY INTEGRATED INTO THE TOP 6" OF SOIL BY MEANS OF ROTOTILLING AFTER CROSS-RIPPING. GROUND COVER & PERENNIAL BED AREAS SHALL BE AMENDED AT A RATE OF 8 CUBIC FEET PER THOUSAND SQUARE FEET OF NITROGEN STABILIZED ORGANIC AMENDMENT AND 10 LBS. OF 12-12-12 FERTILIZER PER CU. YD. ROTOTILLED TO A DEPTH OF 3". NO MANURE OR ANIMAL-BASED PRODUCTS SHALL BE USED FOR ORGANIC AMENDMENTS.

PLANTING

- DECIDUOUS TREES SHALL HAVE FULL, WELL-SHAPED HEADS/ALL EVERGREENS SHALL BE UNSHEARED AND FULL TO THE GROUND; UNLESS OTHERWISE SPECIFIED. TREES WITH CENTRAL LEADERS WILL NOT BE ACCEPTED IF LEADER IS DAMAGED OR REMOVED. PRUNE ALL DAMAGED TWIGS AFTER PLANTING.
- ALL PLANTS WITHIN A SPECIES SHALL HAVE SIMILAR SIZE, AND SHALL BE OF A FORM TYPICAL FOR THE SPECIES. ANY PLANT DEEMED UNACCEPTABLE BY THE LANDSCAPE ARCHITECT SHALL BE IMMEDIATELY REMOVED FROM THE SITE AND SHALL BE REPLACED WITH AN ACCEPTABLE PLANT LIKE TYPE AND SIZE AT THE CONTRACTOR'S OWN EXPENSE. ANY PLANTS APPEARING TO BE UNHEALTHY, EVEN IF DETERMINED TO STILL BE ALIVE, SHALL NOT BE ACCEPTED. THE LANDSCAPE ARCHITECT SHALL BE THE SOLE JUDGE AS TO THE ACCEPTABILITY OF PLANT MATERIAL.

- ALL TREES SHALL BE GUYED AND WOOD STAKED AS PER DETAILS. NO 'T-STAKES' SHALL BE USED FOR TREES.
- ALL PLANT MATERIALS SHALL BE TRUE TO TYPE, SIZE, SPECIES, QUALITY, AND FREE OF INJURY, BROKEN ROOT BALLS, PESTS, AND DISEASES, AS WELL AS CONFORM TO THE AMERICAN STANDARD FOR NURSERY STOCK. FOLLOW GREENCO TREE PLANTING RECOMMENDATIONS FOR MINIMUM QUALITY REQUIREMENTS FOR TREES.
- ALL TREE AND SHRUB BED LOCATIONS ARE TO BE STAKED OUT ON SITE FOR APPROVAL BY THE LANDSCAPE ARCHITECT PRIOR TO INSTALLATION.
- ALL TREES PLANTED ADJACENT TO PUBLIC AND/OR PEDESTRIAN WALKWAYS SHALL BE PRUNED CLEAR OF ALL BRANCHES BETWEEN GROUND AND A HEIGHT OF EIGHT (8) FEET FOR THAT PORTION OF THE PLAN LOCATED OVER THE SIDEWALK AND/OR ROAD.
- LEGACY BUFFALO TURF IS REQUIRED THROUGH GREEN VALLEY TURF COMPANY. 13159 N. US HIGHWAY 65, LITTLETON, CO 80125, (303) 798-6784. CANADIAN BLUE FESCUE IS REQUIRED THROUGH TURF MASTERS COMPANY, 3327 GIDDINGS ROAD FORT COLLINS, CO. 80524 (970) 493.8311. INSTALL AND MAINTAIN IN ACCORDANCE WITH MANUFACTURER'S SPECIFICATIONS.
- ALL PLANT MATERIAL SHALL NOT BE PLANTED PRIOR TO INSTALLATION OF TOPSOIL.
- ALL PLANT BEDS SHALL BE CONTAINED WITH STEEL EDGER. STEEL EDGER IS NOT REQUIRED ALONG CURBS, WALKS OR BUILDING FOUNDATIONS. ALL EDGING SHALL BE 14 GAUGE OVERLAP AT JOINTS A MINIMUM OF 6-INCHES, AND SHALL BE FASTENED WITH A MINIMUM OF 4 PINS PER EACH 10 FOOT SECTION. THE TOP OF ALL EDGING MATERIAL SHALL BE A ROLLED TOP AND 1/2 INCH ABOVE THE FINISHED GRADE OF ADJACENT LAWN OR MULCH AREAS. COLOR: GREEN.
- THE DEVELOPER, HIS SUCCESSOR, OR ASSIGNEE SHALL BE RESPONSIBLE FOR ESTABLISHING AND CONTINUING A REGULAR PROGRAM OF MAINTENANCE FOR ALL LANDSCAPED AREAS. SEE LANDSCAPE GUARANTEE AND MAINTENANCE NOTE.
- A 3-FOOT CLEAR SPACE SHALL BE MAINTAINED AROUND THE CIRCUMFERENCE OF ALL FIRE HYDRANTS.
- LANDSCAPE CONTRACTOR TO SUBMIT SAMPLES OF MISCELLANEOUS LANDSCAPING MATERIALS TO THE LANDSCAPE ARCHITECT AND OWNER'S REPRESENTATIVE FOR APPROVAL PRIOR TO INSTALLATION, I.E., MULCH, EDGER, LANDSCAPE FABRIC, ETC.
- ALL LANDSCAPING SHALL BE INSTALLED BY A TOWN OF CASTLE ROCK REGISTERED LANDSCAPE CONTRACT PROFESSIONAL.
- WHEN NECESSARY, INSTALL STANDARD NURSERY CREEP TAPE NOT LESS THAN 4" WIDE, DESIGNED TO PREVENT WINTER SUN-SCALD. SECURE EVERY 24" BY TAPING. DO NOT USE DUCT TAPE.

MULCHING

- AFTER ALL PLANTING IS COMPLETE, THE CONTRACTOR SHALL INSTALL A MINIMUM 4" THICK LAYER OF MULCH AS SPECIFIED IN THE PLANTING LEGEND. INSTALL A 4" THICK RING OF DOUBLE SHREDDED CEDAR BARK MULCH AROUND ALL PLANT MATERIAL IN ROCK MULCH BEDS WHERE LANDSCAPING IS SHOWN ON THE PLANS. WOOD MULCH RING SIZE SHALL BE 1-1/2" THE SIZE OF THE TOP OF SHRUB, PERENNIAL, AND ORNAMENTAL GRASSES ROOTBALL. TREE RING SIZE SHALL BE GREEN INDUSTRIES OF COLORADO INDUSTRY STANDARD WIDTH.
- ALL MULCH SHALL BE HARVESTED IN A SUSTAINABLE MANNER FROM A LOCAL SOURCE.
- INSTALL DEWITT PRO-5 WEED BARRIER FABRIC UNDER ALL ROCK MULCH SHRUB BEDS SPECIFIED ON THE PLANS ONLY. NO LANDSCAPE FABRIC SHALL BE USED IN WOOD MULCH AREAS. NO PLASTIC WEED BARRIERS SHALL BE SPECIFIED.
- ABSOLUTELY NO EXPOSED GROUND SHALL BE LEFT SHOWING ANYWHERE ON THE PROJECT AFTER MULCH HAS BEEN INSTALLED.
- ALL PLANTING AREAS WITH LESS THAN A 4:1 GRADIENT SHALL RECEIVE A LAYER OF MULCH, TYPE AND DEPTH PER PLANS. SUBMIT 1 CUBIC FOOT SAMPLE OF MULCH (ONE SAMPLE PER TYPE) TO LANDSCAPE ARCHITECT FOR APPROVAL PRIOR TO INSTALLATION. THE MULCH SHALL BE SPREAD EVENLY THROUGHOUT ALL PLANTING AREAS EXCEPT SLOPES 3:1 OR STEEPER, OR AS OTHERWISE DENOTED ON THE PLAN. ABSOLUTELY NO EXPOSED GROUND SHALL REMAIN IN AREAS TO RECEIVE MULCH AFTER MULCH HAS BEEN INSTALLED.
- ALL PLANTING AREAS ON SLOPES OVER 4:1 SHALL RECEIVE COCONUT FIBER EROSION CONTROL NETTING FROM ROLLS. NETTING SHALL BE #C1-125, AS MANUFACTURED BY NORTH AMERICAN GREEN (OR EQUAL). INSTALL AND STAKE PER MANUFACTURER'S SPECIFICATIONS. SEE ALSO THE CIVIL ENGINEER'S EROSION CONTROL PLAN.

IRRIGATION CONCEPT

- AN IRRIGATION PLAN SHALL BE SUBMITTED AFTER THE APPROVAL OF THE LANDSCAPE PLANS.
- AN AUTOMATIC IRRIGATION SYSTEM SHALL BE INSTALLED AND OPERATIONAL BY THE TIME OF FINAL INSPECTION. THE ENTIRE IRRIGATION SYSTEM SHALL BE INSTALLED BY A QUALIFIED IRRIGATION CONTRACTOR.
- THE IRRIGATION SYSTEM WILL OPERATE ON POTABLE WATER, AND THE SYSTEM WILL HAVE APPROPRIATE BACKFLOW PREVENTION DEVICES INSTALLED TO PREVENT CONTAMINATION OF THE POTABLE SOURCE.
- ALL NON-TURF PLANTED AREAS WILL BE DRIP IRRIGATED. SODDED/SEEDED AREAS SHALL BE IRRIGATED WITH SPRAY OR ROTOR HEADS AT 100% HEAD-TO-HEAD COVERAGE.
- ALL PLANTS SHARING SIMILAR HYDROZONE CHARACTERISTICS SHALL BE PLACED ON A VALVE DEDICATED TO PROVIDE THE NECESSARY WATER REQUIREMENTS SPECIFIC TO THAT HYDROZONE.
- THE IRRIGATION SYSTEM SHALL BE DESIGNED AND INSTALLED, TO THE MAXIMUM EXTENT POSSIBLE, TO CONSERVE WATER BY USING THE FOLLOWING DEVICES AND SYSTEMS: MATCHED PRECIPITATION RATE TECHNOLOGY ON ROTOR AND SPRAY HEADS (WHEREVER POSSIBLE), RAIN SENSORS, AND MULTI-PROGRAM COMPUTERIZED IRRIGATION CONTROLLERS FEATURING SENSORY INPUT CAPABILITIES.
- IRRIGATION BACKFLOW PREVENTER SHALL BE SCREENED BY LANDSCAPING. IRRIGATION CONTROLLER SHALL BE SCREENED BY LANDSCAPING IN A VANDAL PROOF LOCKABLE CABINET OR LOCATED WITHIN THE BUILDING UTILITY CLOSET.

LANDSCAPE SITE USE/NARRATIVE

THE PROPOSED DEVELOPMENT AREA WITH THREE MULTI-TENANT BUILDINGS AND THREE FUTURE SINGLE-MULTI-TENANT BUILDINGS TOTALING +/- 45,930 SQ. FT. WILL CREATE APPROXIMATELY 103,415 SQ. FT. OR 25% OF VISUALLY PLEASING, NATIVE, AND ADAPTABLE WATER CONSERVING LANDSCAPING. THE GROUND PLAIN LANDSCAPING HAS BEEN THOROUGHLY ENHANCED WITHIN THE DEVELOPMENT AS WELL AS WAVES OF ORNAMENTAL GRASSES AND DROUGHT TOLERANT TURF PROVIDES AN EYE-LEVEL ENTRY ALONG FACTORY SHOPS BOULEVARD.

THE SITE HAS BEEN DESIGNED TO PULL THE BUILDINGS UP TO THE STREET EDGE ALONG BOTH MEADOWS PARKWAY AND FACTORY SHOPS BOULEVARD WHILE ORIENTING THE PARKING AREAS, DRIVE THRU AND TRASH ENCLOSURES, INTERNAL TO THE SITE. PARKING HAS BEEN PROVIDED ON-SITE IN SUCH A MANNER SO AS TO SCREEN IT FROM THE STREET AND MINIMIZE THE IMPACTS OF LONG RUNS OF PARKING STALLS.

THE PHYSICAL CHARACTERISTICS OF THE SITE AS MENTIONED ON THE SITE ANALYSIS TOGETHER WITH THE PROPOSED BUILDING ORIENTATION ARE SUCH THAT THE ACTIVITY AREAS WILL EFFECTIVELY BE SCREENED FROM BOTH MEADOWS PARKWAY AND FACTORY SHOPS BOULEVARD.

SITE ANALYSIS

THE SITE CONSISTS OF LOTS 4 & 9 OF CASTLE PINES COMMERCIAL FILING NO. 10A AMENDMENT NO. 1 REC. NO. 2015057852 AND IS LOCATED AT THE NORTHWEST CORNER OF MEADOWS PARKWAY AND FACTORY SHOPS BOULEVARD IN THE TOWN OF CASTLE ROCK.

THE PHYSICAL CHARACTERISTICS OF THE SITE ARE SUCH THAT IT IS ROUGHLY AT GRADE ALONG MEADOWS PARKWAY AND FACTORY SHOPS BOULEVARD GREATLY SLOPING DOWN FROM BOTH STREETS TO AN HIGH POINT AT THE NORTHEAST CORNER OF THE SITE. THE SITE HAS BEEN ROUGH GRADED AND STREET UTILITIES AND SIDEWALKS INSTALLED. THE SITE SOILS HAVE BEEN DISTURBED AT ONE TIME AND THEIR CAPACITY WILL BE ESTABLISHED THROUGH NITROGEN AND AMMONIUM PHOSPHATE STABILIZED ORGANIC AMENDMENT FOR CONSTRUCTION. THE SITE HAS A SOUTHERN ASPECT/EXPOSURE WITH NO OUTSTANDING NATURAL FEATURES OR ADJACENT ARCHITECTURE THAT WOULD BLOCK OR IMPACT SOLAR ACCESS OR PREVAILING SOUTHERLY AND NORTHWESTERLY WINDS.

THERE IS EXISTING NATIVE GRASS VEGETATION ON-SITE. ALL STORM WATER RUNOFF FROM THE SITE WILL BE PICKED UP ON SITE BY STORM SEWERS AND TRANSPORTED TO THE EXISTING REGIONAL BASIN.

LANDSCAPE SHEET INDEX

- SHEET 1 - OVERALL LANDSCAPE PLAN AND NOTES
- SHEET 2 - LANDSCAPE PLAN - AMENDMENT, LEGEND, CALCULATIONS AND DETAILS

OVERALL LANDSCAPE PLAN AND NOTES

SCALE: 1" = 60'

TOWN OF CASTLE ROCK REGISTRATION INFORMATION:
CERTIFIED LANDSCAPE ARCHITECT: JOSEPH L. WILSON
TOWN OF CASTLE ROCK REGISTRATION NUMBER: #15-1175
LICENSED LANDSCAPE ARCHITECT STATE OF COLORADO: LA-304

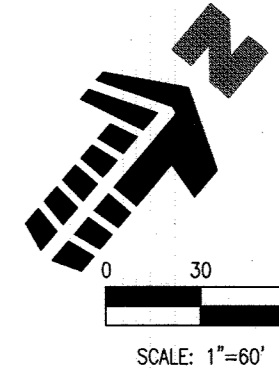

TOWN OF CASTLE ROCK'S CONCEPTUAL LANDSCAPE PLAN STANDARD NOTES

- SQUARE FOOTAGES ARE ESTIMATED. FINAL LANDSCAPE AREA COVERAGE SHALL MEET OR EXCEED COVERAGE REPRESENTED IN THIS DRAWING AND SHALL CONFORM TO SUBSEQUENT SUBMITTAL REQUIREMENTS.
- QUANTITIES AND LOCATIONS OF PLANT MATERIALS ARE APPROXIMATED. FINAL QUANTITIES AND LOCATIONS WILL BE REFLECTED ON CONSTRUCTION DOCUMENTS.
- ALL PLANTS ARE TO BE PROPERLY HYDROZONED PER TOWN OF CASTLE ROCK PLAN LIST.
- DISTANCE OF TREES TO UTILITY LINES SHOULD BE A MINIMUM OF 10 FEET.
- PERMANENT IRRIGATION IS REQUIRED FOR ALL LANDSCAPED AREAS GREATER THAN 500 SQUARE FEET, PER SECTION 4.2.3 OF THE LANDSCAPE AND IRRIGATION MANUAL.
- DESIGN MUST ACCOMMODATE THE WATERING RESTRICTIONS AS OUTLINED IN THE TOWN OF CASTLE ROCK WATER USE MANAGEMENT PLAN (WUMP).
- IRRIGATION SYSTEMS ARE TO BE DESIGNED TO OPERATE WITHIN THE TOWN OF CASTLE ROCK WATER USE MANAGEMENT PLAN.
- IRRIGATION SYSTEMS ARE TO BE DESIGNED PER THE TOWN OF CASTLE ROCK LANDSCAPE AND IRRIGATION REGULATIONS SECTION 4.2.3 AND TO CORRELATE WITH THE USE TYPE ON THE PROPERTY.
- IF ANY TRANSFORMERS, GROUND-MOUNTED HVAC UNITS, UTILITY PEDESTALS, AND SIMILAR FEATURES ARE NOT SHOWN ON THE GSP, ADDITIONAL LANDSCAPING AND SCREENING MAY BE REQUIRED BASED UPON FIELD CONDITIONS DURING THE SITE INSPECTION PRIOR TO ISSUANCE OF THE CERTIFICATE OF OCCUPANCY, OR FINAL INSPECTION, AS APPLICABLE.
- NO SOLID OBJECT EXCEEDING 30" IN HEIGHT ABOVE THE FLOWLINE ELEVATION OF THE ADJACENT STREET, INCLUDING BUT NOT LIMITED TO BUILDING, UTILITY CABINETS,

- WALLS, FENCES, TREES, LANDSCAPE PLANTINGS, CROPS, CUT SLOPES AND BERMS, SHALL BE PLACED IN SIGHT DISTANCE TRIANGLE OR EASEMENTS AS SHOWN ON THIS PLAN.
- NO TREES, LARGE SHRUBS, OR PERMANENT STRUCTURES ARE ALLOWED IN UTILITY AND DRAINAGE EASEMENTS.
- AN IRRIGATION PLAN WILL BE REQUIRED ON THE FIRST REVIEW OF THE CONSTRUCTION DOCUMENTS. PLEASE SEE SECTIONS 3.1.2B AND 4.2.3 IN THE TOWN OF CASTLE ROCK LANDSCAPE AND IRRIGATION PERFORMANCE STANDARDS AND CRITERIA FOR IRRIGATION SUBMITTAL AND DESIGN REQUIREMENTS. IRRIGATION SYSTEM IS TO BE REVIEWED AND APPROVED WITH CONSTRUCTION DOCUMENTS. CHANGES MAY BE NECESSARY ON THE LANDSCAPE PLAN DUE TO FIRST IRRIGATION REVIEW ON THE CONSTRUCTION DOCUMENTS.
- TREES, LARGE SHRUBS AND PERMANENT STRUCTURES ARE NOT ALLOWED IN UTILITY OR DRAINAGE EASEMENTS IN THE TOWN OF CASTLE ROCK.
- LANDSCAPE AND IRRIGATION SHALL BE INSTALLED BY A TOWN OF CASTLE ROCK REGISTERED LANDSCAPE CONTRACT PROFESSIONAL.
- CONTACT THE TOWN OF CASTLE ROCK UTILITIES DEPARTMENT AT 720.733.6045 FOR AN ON-SITE PRE-CONSTRUCTION MEETING BEFORE BEGINNING INSTALLATION OF THE LANDSCAPING.
- INSTALLING CONTRACTOR IS TO PROVIDE SUBMITTAL FROM SUPPLIERS FOR SOD AND NATIVE SEED MIX AT TIME OF LANDSCAPE INSPECTION.
- SOIL INSPECTION IS REQUIRED BEFORE SOD INSTALLATION AND SHOULD BE SCHEDULED ONLINE AT WWW.CRGOV.COM.
- SLOPES GREATER THAN 3:1 ARE NOT PERMITTED ON LANDSCAPE PLANS IN THE TOWN OF CASTLE ROCK.

LANDSCAPE GUARANTEE AND MAINTENANCE

- THE LANDSCAPE CONTRACTOR SHALL GUARANTEE ALL TREES, SHRUBS, PERENNIALS, SOD, AND IRRIGATION SYSTEMS FOR A PERIOD OF ONE YEAR FROM THE DATE OF THE OWNER'S ACCEPTANCE. THE CONTRACTOR SHALL MEET ALL TOWN OF CASTLE ROCK MAINTENANCE REQUIREMENTS AND SHALL REPLACE, AT HIS OWN EXPENSE, ANY PLANTS WHICH DIE IN THAT TIME, OR REPAIR ANY PORTIONS OF THE IRRIGATION SYSTEM WHICH OPERATE IMPROPERLY. LANDSCAPING WITHIN PUBLIC RIGHTS-OF-WAY IS TO BE MAINTAINED BY THE ADJACENT PRIVATE PROPERTY OWNER.
- THE LANDSCAPE CONTRACTOR SHALL MAINTAIN THE LANDSCAPE IN A NEAT, CLEAN, AND HEALTHY CONDITION FOR A PERIOD OF 90 DAYS. THIS SHALL INCLUDE PROPER PRUNING, MOWING AND AERATION OF LAWNS, WEEDING, REPLACEMENT OF MULCH, REMOVAL OF LITTER, AND THE APPROPRIATE WATERING OF ALL PLANTINGS. IRRIGATION SHALL BE MAINTAINED IN PROPER WORKING ORDER, WITH SCHEDULING ADJUSTMENTS BY SEASON AND TO MAXIMIZE WATER CONSERVATION. IF SITE OPENS DURING WINTER, TO AVOID FREEZE DAMAGE ON PLANTINGS, THE 90 DAYS SHOULD BEGIN AFTER ACCEPTANCE OF THE WORK.
- AFTER THE INITIAL MAINTENANCE PERIOD AND DURING THE GUARANTEE PERIOD, THE LANDSCAPE CONTRACTOR SHALL ONLY BE RESPONSIBLE FOR REPLACEMENT OF PLANTS WHEN PLANT DEATH CANNOT BE ATTRIBUTED DIRECTLY TO OVERWATERING OR OTHER DAMAGE BY HUMAN ACTIONS.
- DURING THE LANDSCAPE MAINTENANCE PERIOD, THE LANDSCAPE CONTRACTOR SHALL MAINTAIN POSITIVE DRAINAGE AWAY FROM STRUCTURES IN ALL LANDSCAPE AREAS AT THE MINIMUM SLOPE SPECIFIED IN THE GEOTECHNICAL REPORT. LANDSCAPE AREAS WHICH SETTLE AND CREATE THE POTENTIAL FOR PONDING SHALL BE REPAIRED TO ELIMINATE PONDING POTENTIAL AND BLEND IN WITH THE SURROUNDING GRADES. SHOULD ANY CONFLICTS AND/OR DISCREPANCIES ARISE BETWEEN THE GEOTECHNICAL REPORT, THE GRADING PLANS, THESE NOTES, AND ACTUAL CONDITIONS, THE CONTRACTOR SHALL IMMEDIATELY BRING SUCH ITEMS TO THE ATTENTION OF THE LANDSCAPE ARCHITECT AND OWNER.

#	Date	Issue / Description
-	10-19-15	SOP AMENDMENT
-	11-16-15	SOP AMENDMENT RESUBMITTAL

Project No: _____
Drawn By: _____ J.L.W.
Checked By: _____ J.L.W.
Date: 7/11/2014
Sheet File: _____

DRAWN TITLE:
OVERALL LANDSCAPE PLAN AND NOTES

