

SITE DEVELOPMENT PLAN, AMENDMENT NO. 1
CASTLE ROCK INDUSTRIAL BUILDING 2, CALIBER COLLISION FINISH-OUT
LOT 2, THE MEADOWS FILING 19, PARCEL 2 NORTH
LOCATED IN THE NORTHWEST ONE-QUARTER OF SECTION 28, TOWNSHIP 7 SOUTH, RANGE 67 WEST OF THE 6th PRINCIPAL MERIDIAN, TOWN OF CASTLE ROCK, COUNTY OF DOUGLAS, STATE OF COLORADO
TOWN OF CASTLE ROCK PROJECT NO. SDP23-0010

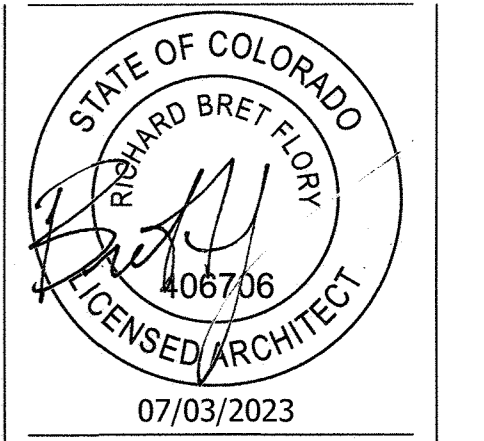

ARCHITECT:
BRET FLORY
1913 GARDEN GROVE COURT
PLANO, TX 75075
P: 972.467.9749

CALIBER COLLISION
TIMBER MILL PARKWAY
CASTLE ROCK, CO

GENERAL NOTES

- 1. THE TOWN OF CASTLE ROCK REQUIRES THAT MAINTENANCE ACCESS BE PROVIDED TO ALL STORM DRAINAGE FACILITIES TO ASSURE CONTINUOUS OPERATIONAL CAPABILITY OF THE SYSTEM. THE PROPERTY OWNER, SUBSEQUENT OWNERS, HEIRS, SUCCESSORS AND ASSIGNS SHALL BE RESPONSIBLE FOR THE MAINTENANCE OF ALL DRAINAGE FACILITIES INCLUDING, BUT NOT LIMITED TO, INLETS, PIPES, CULVERTS, CHANNELS, DITCHES, HYDRAULIC STRUCTURES, AND DETENTION BASINS LOCATED ON THIS PROPERTY, UNLESS MODIFIED BY THE SUBDIVISION IMPROVEMENTS AGREEMENT. SHOULD THE OWNER FAIL TO ADEQUATELY MAINTAIN SAID FACILITIES, THE TOWN SHALL HAVE THE RIGHT TO ENTER SAID PROPERTY FOR THE PURPOSES OF OPERATION AND MAINTENANCE. ALL SUCH MAINTENANCE COSTS WILL BE ASSESSED TO THE PROPERTY OWNER, SUBSEQUENT OWNERS, HEIRS, SUCCESSORS AND ASSIGNS. THE MAINTENANCE COSTS SHALL INCLUDE ALL ACTUAL COSTS FOR LABOR, EQUIPMENT AND MATERIALS AND A 25% FEE.
2. PURSUANT TO SECTION 4.3 AND 8.2.3 OF THE TOWN OF CASTLE ROCK LANDSCAPE REGULATIONS, THE PROPERTY OWNER, SUBSEQUENT OWNERS, HEIRS, SUCCESSORS AND ASSIGNS SHALL BE RESPONSIBLE FOR THE PROPER MAINTENANCE OF THE AREA SUBJECT TO THE APPROVED SITE DEVELOPMENT PLAN. LANDSCAPING WITHIN PUBLIC RIGHTS-OF-WAY IS TO BE MAINTAINED BY THE ADJACENT PRIVATE PROPERTY OWNER OR THE HOMEOWNER/PROPERTY OWNER ASSOCIATION, AS APPLICABLE. LANDSCAPING SHALL BE CONTINUOUSLY MAINTAINED INCLUDING NECESSARY WATERING, WEEDING, PRUNING, MOWING, PEST CONTROL, AND REPLACEMENT OF DEAD OR DISEASED PLANT MATERIAL. UPON WRITTEN NOTICE BY THE TOWN, THE OWNER WILL HAVE 45 DAYS TO CURE OR REPLACE DAMAGED OR DEAD LANDSCAPE MATERIAL. IN THE CASE OF DISEASED LANDSCAPE MATERIAL, A SHORTER COMPLIANCE PERIOD MAY BE SPECIFIED IN SAID NOTICE. THE TOWN OF CASTLE ROCK WATER CONSERVATION ORDINANCE REGULATES TIMES OF SEASONAL IRRIGATION AND PROHIBITS THE WASTING OF POTABLE WATER THROUGH IMPROPER IRRIGATION.
3. THE PROVIDED LANDSCAPE COUNTS IN THE SITE DEVELOPMENT PLAN ARE MINIMUM REQUIRED COUNTS. ANY CHANGES TO THE PROVIDED LANDSCAPE COUNTS SHALL REQUIRE AN SDP AMENDMENT. THE LOCATION OF PLANT MATERIAL IS SUBJECT TO CHANGE DUE TO FIELD CONDITIONS WITH REVIEW OF THE CONSTRUCTION DOCUMENTS.
4. THIS PROPERTY IS LOCATED WITHIN ZONE X AS PER FEMA FIRM PANEL NO. 08035C0167G DATED 3/16/2016.
5. ANY STREET SIGNS, STRIPING, STREET LIGHTS AND CURB RAMPS ARE CONCEPTUAL ONLY AND SUBJECT TO TOWN REVIEW WITH THE CONSTRUCTION DOCUMENTS. THESE ITEMS SHALL COMPLY WITH THE TOWN OF CASTLE ROCK'S REGULATIONS, STANDARDS AND REQUIREMENTS.
6. THE DEVELOPER SHALL CONFORM TO THE TOWN OF CASTLE ROCK IMPLEMENTATION POLICY, AS AMENDED FROM TIME TO TIME, FOR THIS PROJECT.
7. APPROVAL OF THIS SITE DEVELOPMENT PLAN DOES NOT CONSTITUTE APPROVAL OF ANY DEVIATIONS FROM TOWN OF CASTLE ROCK REGULATIONS AND STANDARDS. ALL DEVIATIONS FROM TOWN REGULATIONS AND STANDARDS ARE SUBJECT TO THE APPROPRIATE PROCEDURES FOR APPROVAL.
8. NO SOLID OBJECT (EXCLUDING FIRE HYDRANTS, TRAFFIC CONTROL DEVICES AND TRAFFIC SIGNS) EXCEEDING THIRTY (30) INCHES IN HEIGHT ABOVE THE FLOWLINE ELEVATIONS OF THE ADJACENT STREET, INCLUDING BUT NOT LIMITED TO BUILDINGS, UTILITY CABINETS, WALLS, FENCES, LANDSCAPE PLANTINGS, CROPS, CUT SLOPES, AND BERMS SHALL BE PLACED WITHIN SIGHT DISTANCE LINES AND SIGHT DISTANCE EASEMENTS.
9. ALL UTILITY, DRAINAGE, EMERGENCY ACCESS, SIGHT DISTANCE AND PUBLIC ACCESS/TRAIL EASEMENTS AS SHOWN ON THE SITE DEVELOPMENT PLAN SHALL BE GRANTED TO THE TOWN OF CASTLE ROCK WITH THE PLAT.
10. THIS SITE IS ZONED PD.
11. ALL EMERGENCY ACCESS ROADS, EMERGENCY ACCESS GATES AND SIGNAGE SHALL COMPLY WITH THE TOWN OF CASTLE ROCK FIRE DEPARTMENT REQUIREMENTS AND SHALL BE MAINTAINED BY METROPOLITAN DISTRICT, HOMEOWNERS ASSOCIATION, OR OTHER PROPERTY MANAGEMENT ENTITY.
12. UNLESS OTHERWISE NOTED, ALL LOTS SHALL HAVE A 10-FOOT UTILITY EASEMENT ALONG THE FRONT AND REAR LOT LINES AND ALONG ALL PUBLIC RIGHTS-OF-WAY AND SHALL HAVE 5-FOOT UTILITY EASEMENTS ALONG EACH SIDE LOT LINE. THESE UTILITY EASEMENTS ARE FOR THE INSTALLATION, MAINTENANCE AND OPERATION OF UTILITIES AND DRAINAGE FACILITIES INCLUDING, BUT NOT LIMITED TO STREET LIGHTS, ELECTRIC LINES, GAS LINES, CABLE TELEVISION LINES, FIBER OPTIC LINES AND TELEPHONE LINES, AS WELL AS PERPETUAL RIGHT FOR INGRESS AND EGRESS FOR INSTALLATION, MAINTENANCE AND REPLACEMENT OF SUCH LINES.
13. RETAINING WALLS, SECTIONS OF RETAINING WALLS GREATER THAN 4-FEET IN HEIGHT AS MEASURED FROM THE BOTTOM OF THE FOOTING TO THE TOP OF THE WALL AND RETAINING WALLS, REGARDLESS OF HEIGHT, WHICH RETAIN A SURCHARGE OR TIERED WALLS MUST BE DESIGNED BY A STRUCTURAL ENGINEER LICENSED IN THE STATE OF COLORADO AND MUST RECEIVE A BUILDING PERMIT FROM THE TOWN OF CASTLE ROCK.
14. A SIGN PERMIT FOR EACH SIGN MUST BE OBTAINED FROM THE TOWN OF CASTLE ROCK BUILDING DIVISION PRIOR TO PLACING ANY SIGN ON THE PROPERTY. ALL SIGNS MUST COMPLY WITH THE PROVISIONS OF TITLE 19 (SIGN CODE REGULATIONS) OF THE MUNICIPAL CODE.
15. THE PROJECT IS LOCATED IN THE MEADOWS HABITAT CONSERVATION PLAN BOUNDARY, WHICH HAS APPROVAL FROM THE U.S. FISH AND WILDLIFE SERVICE.
16. THE NUMBER OF PARKING SPACES HAS BEEN SET BASED ON THE PROPOSED USES ON THIS SITE DEVELOPMENT PLAN AND CHAPTER 17.54 OF THE CASTLE ROCK MUNICIPAL CODE. A CHANGE OF USE TO A MORE PARKING INTENSIVE USE AS IDENTIFIED IN CHAPTER 17.54 OF THE CASTLE ROCK MUNICIPAL CODE WILL REQUIRE AN AMENDMENT TO THIS SITE DEVELOPMENT PLAN.
17. STORAGE WITHIN CORE 75-FOOT EASEMENT IS LIMITED TO 8-FEET TALL AND MUST MAINTAIN CLEAR PATHWAY OF 20-FEET ON EITHER SIDE OF THE EXISTING 115 KV TRANSMISSION LINE.

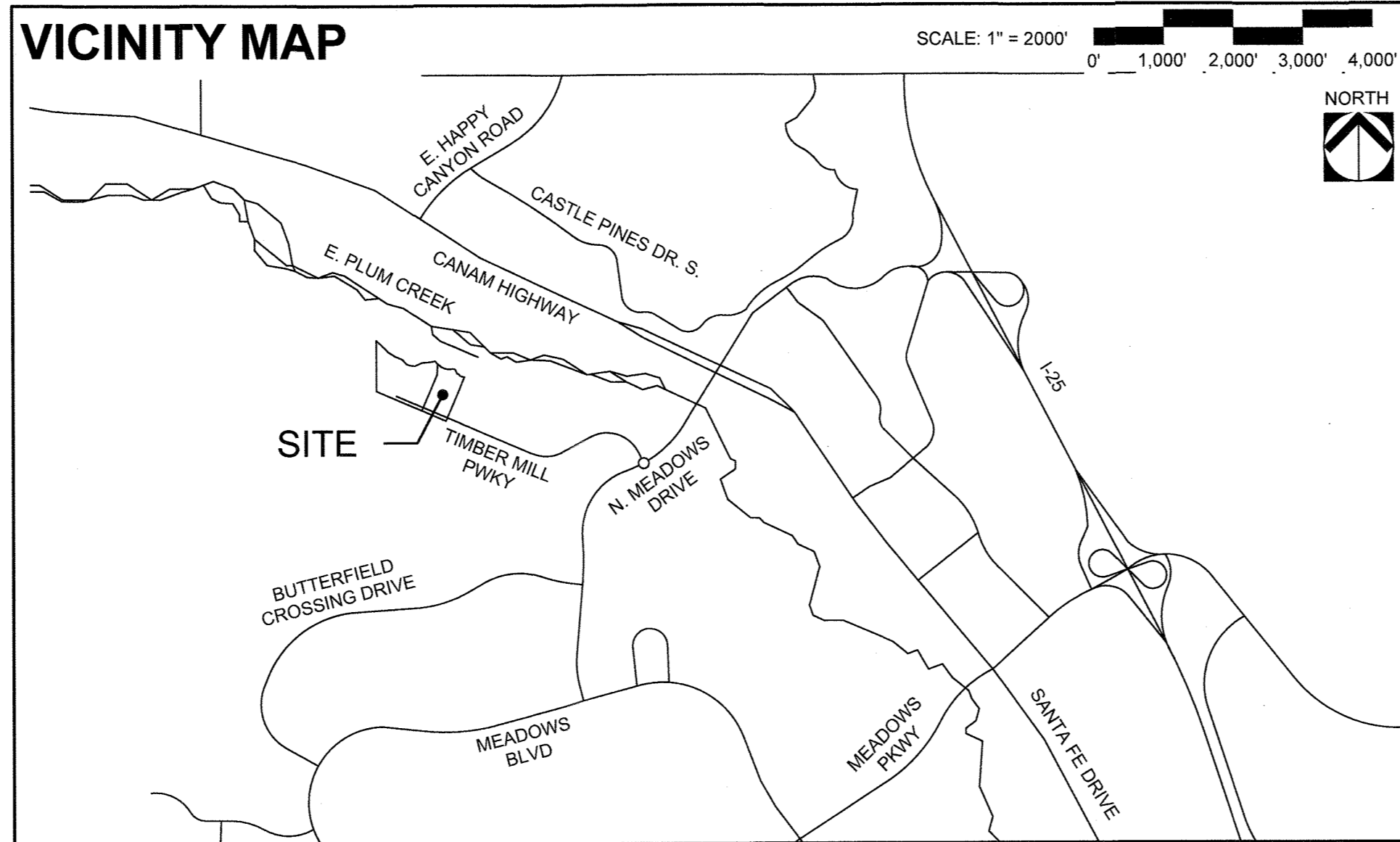

PURPOSE STATEMENT: THIS SITE DEVELOPMENT PLAN IS FOR THE PROPOSED DEVELOPMENT OF A NEW OUTDOOR STORAGE AREA.

BENCHMARK: DOUGLAS AS COUNTY CONTROL MONUMENT 2.015030 (AZTEC #910). RECOVERED 3.25" ALUMINUM CAP LOCATED 410' MORE OR LESS, EAST OF THE RAILROAD TRACKS AND 3200', MORE OR LESS, NORTH OF MEADOWS PARKWAY. ELEVATION = 6082.185 (NAVD 88).

BASIS OF BEARINGS: BEARINGS ARE BASED ON THE WEST LINE OF SAID SECTION 28, TOWNSHIP 7 SOUTH, RANGE 67 WEST OF THE 6TH PRINCIPAL MERIDIAN, BEING MONUMENTED AT THE NORTHWEST CORNER BY A NO. 6 REBAR WITH 2.5" BRASS CAP STAMPED "PELS 7124" AND AT THE SOUTHWEST CORNER BY A NO. 6 REBAR WITH A 3" BRASS CAP STAMPED "PLS 235152004", ASSUMED TO BEAR S 00°04'11" W, 5,266.05 FEET.

LEGAL DESCRIPTION: THE MEADOWS FILING 19, PARCEL 2 NORTH, LOT 2

A PARCEL OF LAND SITUATED IN THE NORTHWEST QUARTER OF SECTION 28, TOWNSHIP 7 SOUTH, RANGE 67 WEST OF THE SIXTH PRINCIPAL MERIDIAN, COUITY OF DOUGLAS, STATE OF COLORADO, MORE PARTICULARLY DESCRIBED AS FOLLOWS:

PROJECT TEAM
OWNER: CRIM BORROWER LLC
STRUCTURAL ENGINEER: MICHAEL J. MCLAREN, P.E.
MEP ENGINEER: JORDAN & SKALA ENGINEERS
ARCHITECT: BRET FLORY ARCHITECT

SUMMARY TABLE
ZONING: THE MEADOWS FOURTH AMENDMENT PD
C-O-I-COMMERCIAL, OFFICE, INDUSTRIAL
USE AREA: OFFICE/WAREHOUSE
LOT SIZE: 232,715 SF (5.342 AC)
BUILDING COVERAGE: 34% (80,000 SF)
BUILDING SETBACKS: FRONT = 19', REAR = 180', SIDE (EAST) = 130', SIDE (WEST) = 45'
BUILDING HEIGHT: 60' MAX
BUILDING SEPARATION: N/A
PARKING: 100 SPACES (INCLUDING: (4) VAN ACCESSIBLE PARKING SPACES)
TOTAL PARKING REQUIRED: 56 SPACES

OWNERSHIP CERTIFICATION:

THE UNDERSIGNED ARE ALL THE OWNERS OF CERTAIN LANDS IN THE TOWN OF CASTLE ROCK, COUNTY OF DOUGLAS AND STATE OF COLORADO DESCRIBED HEREIN.

SIGNED THIS 26 DAY OF JULY 2023

NOTARY BLOCK:

SUBSCRIBED AND SWORN TO BEFORE ME THIS 23 DAY OF July 2023 BY Gregory Schmidt

WITNESS MY HAND AND OFFICIAL SEAL.

NOTARY PUBLIC: Cindy Williams

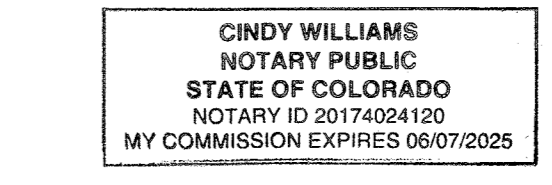

LIENHOLDER SUBORDINATION CERTIFICATION:

THE UNDERSIGNED ARE ALL THE MORTGAGEES AND LIENHOLDERS OF CERTAIN LANDS IN THE TOWN OF CASTLE ROCK, COUNTY OF DOUGLAS AND STATE OF COLORADO DESCRIBED HEREON. THE UNDERSIGNED BENEFICIARY OF THE LINE CREATED BY THE INSTRUMENT RECORDED June 9th 2023 AT RECEPTION NO. 2022091219, DOUGLAS COUNTY, COLORADO, SUBORDINATES THE SUBJECT LIEN TO THE TERMS, CONDITIONS AND RESTRICTIONS OF THIS DOCUMENT

PACIFIC WESTERN BANK

NOTARY BLOCK:

SUBSCRIBED AND SWORN TO BEFORE ME THIS 26 DAY OF July 2023 BY Chris Erickson, EVP

WITNESS MY HAND AND OFFICIAL SEAL.

NOTARY PUBLIC: Laura D Mendez

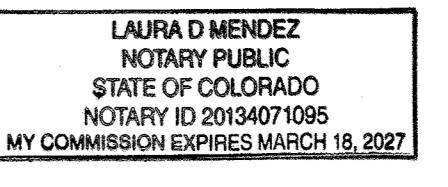

TITLE CERTIFICATION:

SCOTT BENNETTS, AN AUTHORIZED REPRESENTATIVE OF LAND TITLE GUARANTEE COMPANY, A TITLE INSURANCE COMPANY LICENSED TO DO BUSINESS IN THE STATE OF COLORADO, HAVE MADE AN EXAMINATION OF THE PUBLIC RECORDS AND STATE THAT ALL OWNERS, MORTGAGEES AND LIENHOLDERS OF THE PROPERTY ARE LISTED IN THE CERTIFICATE OF OWNERSHIP AND LIENHOLDER SUBORDINATION CERTIFICATE.

SCOTT BENNETTS

LAND TITLE GUARANTEE COMPANY

SIGNED THIS 27th DAY OF July 2023

TITLE COMPANY

SUBSCRIBED AND SWORN TO BEFORE ME THIS 27th DAY OF July 2023

BY SCOTT BENNETTS AS AUTHORIZED REPRESENTATIVE

OF LAND TITLE GUARANTEE COMPANY

WITNESS MY HAND AND OFFICIAL SEAL.

NOTARY PUBLIC: Andy John Stenman

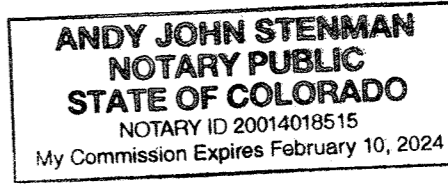

ARCHITECT'S STATEMENT

I, BRET FLORY, BEING A REGISTERED PROFESSIONAL ARCHITECT IN THE STATE OF COLORADO, HEREBY ATTEST THAT ALL ROADWAY, GRADING, UTILITY AND DRAINAGE IMPROVEMENTS IDENTIFIED ON THIS SITE DEVELOPMENT PLAN HAVE BEEN DESIGNATED AND ENGINEERED IN CONFORMANCE WITH ALL TOWN OF CASTLE ROCK PUBLIC WORKS CONSTRUCTION STANDARDS.

BRET FLORY, LIC. NO. 406706

DATE: 8/2/23

STATEMENT OF DIRECTOR OF DEVELOPMENT SERVICES APPROVAL: THIS SITE DEVELOPMENT PLAN WAS APPROVED BY THE DIRECTOR OF DEVELOPMENT SERVICES OF THE TOWN OF CASTLE ROCK, COLORADO ON THE 9 DAY OF August 2023.

DIRECTOR OF DEVELOPMENT SERVICES

DOUGLAS COUNTY CLERK AND RECORDER'S CERTIFICATE:

THIS SITE DEVELOPMENT PLAN WAS FILED FOR RECORD IN THE OFFICE OF THE COUNTY CLERK AND RECORDER OF DOUGLAS COUNTY AT 4:43 PM ON THE 9th DAY OF August 2023 AT RECEPTION NO. 2023034364

DOUGLAS COUNTY CLERK AND RECORDER

BY Sheri Davis, Deputy



WATER RIGHTS DEDICATION AGREEMENT: THE PROVISION OF MUNICIPAL WATER TO THIS SUBDIVISION IS SUBJECT TO THE TERMS AND CONDITIONS OF THE MEADOWS (FOURTH AMENDMENT) DEVELOPMENT AGREEMENT, RECORDED ON THE 10th DAY OF JULY, 2023 AT RECEPTION NO. 2003102970 ACCORDINGLY 4.33 SFE WERE PREVIOUSLY DEBITED FROM THE WATER BANK PER SDP21-0045, RECORDED ON THE 1ST DAY OF JUNE, 2022 AT RECEPTION NO. 2022039143

SHEET INDEX
ARCHITECTURAL
1 of 4 CS.01 COVER SHEET AND CODE DATA
2 of 4 SP1.0 SITE PLAN AND DETAILS
3 of 4 SP1.1 SITE DETAILS
4 of 4 A2.0 EXTERIOR ELEVATIONS

DOCUMENT DATE: 03/22/2023
PROJECT NUMBER: 23516
REVISIONS
DRAWINGS ISSUED FOR: PERMIT
SHEET NUMBER: CS.01
COVER SHEET AND CODE DATA
1 OF 4
COPYRIGHT © 2023





