

2004053764 3 PGS

PLAT IDENTIFICATION SHEET

OFFICIAL RECORDS
DOUGLAS COUNTY CO
CAROLE R. MURRAY
CLERK & RECORDER
RECORDING FEE: \$21.00
3 PGS

GRANTOR: US Home Corporation
(OWNER) Town of Castle Rock

2004053764
05/26/2004 11:14 AM

GRANTEE: Red Hawk Filing No. 2, 1st Amendment
(NAME OF PLAT)

OLD LEGAL:

Section: 3

Township: 8

Range: 67

NEW LEGAL:

Subdivision/Condo Name: Red Hawk

Filing # 2

Phase

Lot #

Building #

Block #

Unit #

RED HAWK FILING NO. 2, 1ST AMENDMENT

CORRECTION OF TRACT OWNERSHIP

TOWNSHIP 8 SOUTH, RANGE 67 WEST OF THE 6TH PRINCIPAL MERIDIAN
TOWN OF CASTLE ROCK, COUNTY OF DOUGLAS, STATE OF COLORADO
SHEET 1 OF 2

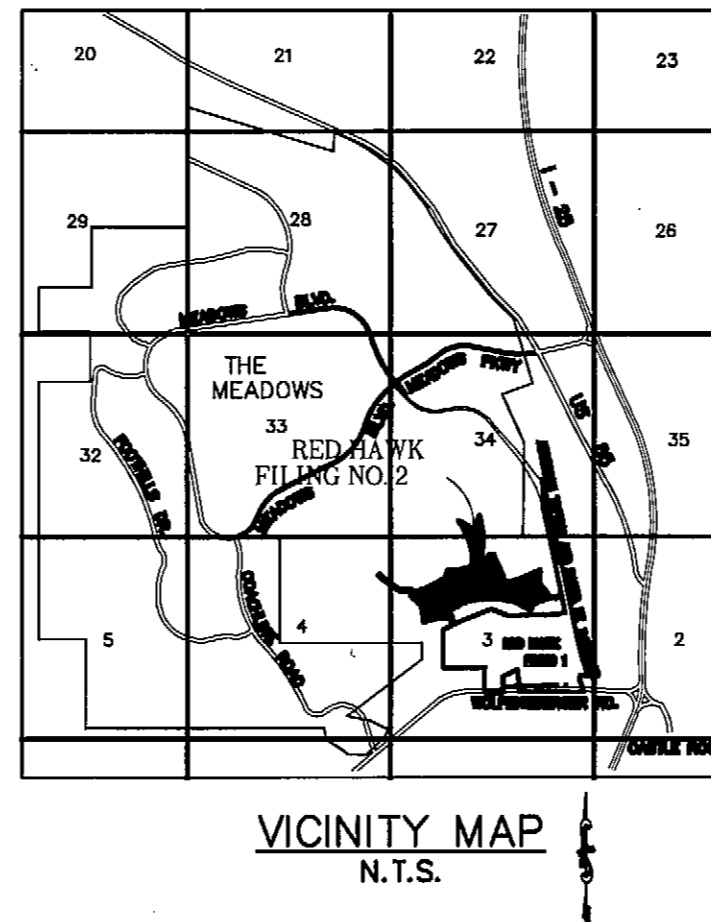

LEGAL DESCRIPTION

TRACTS A-S, RED HAWK FILING NO. 2, ACCORDING TO THE RECORDED PLAT, TOWN OF CASTLE ROCK, COUNTY OF DOUGLAS, STATE OF COLORADO.

NOTES:

- 1) BOUNDARY CORNERS SET BY R.M.C., INC. ARE #5 REBAR WITH PLASTIC CAPS BEARING SURVEYOR'S REGISTRATION NO. 9329 AND ARE INDICATED BY
- 2) DATE OF SURVEY: MAY, 1999
- 3) BEARINGS ARE BASED ON THE SOUTH LINE OF THE NORTH HALF OF THE SOUTHEAST QUARTER OF SECTION 3, TOWNSHIP 8 SOUTH, RANGE 67 WEST OF THE SIXTH PRINCIPAL MERIDIAN BEARING NORTH 89°45'20" EAST.
- 4) NOTICE: "ACCORDING TO COLORADO LAW, YOU MUST COMMENCE ANY LEGAL ACTION BASED UPON ANY DEFECT IN THIS SURVEY WITHIN THREE YEARS AFTER YOU FIRST DISCOVER SUCH DEFECT. IN NO EVENT, MAY ANY ACTION BASED UPON ANY DEFECT IN THIS SURVEY BE COMMENCED MORE THAN TEN YEARS FROM THE DATE OF THE CERTIFICATION SHOWN HEREON."
- 5) TRACTS B, F, G, H, L, M, N, O, P, Q, R & S ARE PUBLIC LAND DEDICATIONS TO BE USED FOR PUBLIC ACCESS AND OTHER PUBLIC PURPOSES AND SHALL BE OWNED AND MAINTAINED BY THE TOWN OF CASTLE ROCK.
- 6) TRACTS A, C, D, E, I, J & K ARE TO BE DEDICATED AS PRIVATE OPEN SPACE TO THE HOMEOWNERS ASSOCIATION FOR RED HAWK FILING NO.2 AND WILL BE USED FOR UTILITIES, DRAINAGE, OPEN SPACE, TRAILS/SIDEWALKS FOR PUBLIC ACCESS, SIGNAGE, ENTRY FEATURES AND PARK FACILITIES, OWNED AND MAINTAINED BY THE HOMEOWNERS ASSOCIATION.
- 7) ALL BLOCK CORNER RADII ARE 13.00' UNLESS NOTED.
- 8) INDICATES A FOUND PIN & CAP BEARING REGISTRATION NO.6935
- 9) INDICATES A FOUND 5/8" REBAR
- 10) ANY PERSON WHO KNOWINGLY REMOVES, ALTERS OR DEFACES ANY PUBLIC LAND SURVEY MONUMENT, OR LAND BOUNDARY MONUMENT OR ACCESSORY COMMITS A CLASS 2 MISDEMEANOR PURSUANT TO STATE STATUTE 18-4-508 C.R.S.

SURVEYOR'S CERTIFICATE

I, DUWAYNE M. PHILLIPS, A PROFESSIONAL LAND SURVEYOR REGISTERED IN THE STATE OF COLORADO, DO HEREBY CERTIFY THAT THIS PLAT TRULY AND CORRECTLY REPRESENTS THE RESULTS OF A SURVEY MADE DURING JANUARY, 1997 BY ME OR UNDER MY DIRECT SUPERVISION AND THAT ALL MONUMENTS EXIST AS SHOWN HEREON; THAT MATHEMATICAL CLOSURE ERRORS ARE LESS THAN 1:50,000 (SECOND ORDER); AND THAT SAID PLAT HAS BEEN PREPARED IN FULL COMPLIANCE WITH ALL APPLICABLE LAWS OF THE STATE OF COLORADO DEALING WITH MONUMENTS, SUBDIVISIONS, OR SURVEYING OF LAND AND ALL PROVISIONS, WITHIN MY CONTROL, OF THE TOWN OF CASTLE ROCK SUBDIVISION REGULATIONS.

DUWAYNE M. PHILLIPS
PLS. NO. 1145

August 26, 2002
DATE

CERTIFICATE OF DEDICATION AND OWNERSHIP

THE UNDERSIGNED, BEING ALL THE OWNERS, MORTGAGEES AND LIEN HOLDERS OF CERTAIN LANDS IN THE TOWN OF CASTLE ROCK, DOUGLAS COUNTY, COLORADO, HEREBY DEDICATE THE SAME INTO TRACTS AS SHOWN ON THIS PLAT UNDER THE NAME AND STYLE OF RED HAWK FILING NO. 2, 1ST AMENDMENT. THE UNDERSIGNED HEREBY DEDICATES TRACT L TO THE TOWN OF CASTLE ROCK FOR PURPOSES OF OWNERSHIP AND MAINTENANCE. TRACTS C, I AND J ARE OWNED BY THE TOWN OF CASTLE ROCK AND WILL BE CONVEYED BY SEPARATE INSTRUMENT TO US HOME CORPORATION.

OWNERS:

US HOME CORPORATION
A DELAWARE CORPORATION

ATTEST:

BY: AS S.I.V.P.

FOR US HOME CORPORATION.

SUBSCRIBED AND SWORN TO BEFORE ME THIS 26th DAY OF August, 2002

BY:

WITNESS MY HAND AND OFFICIAL SEAL.

NOTARY PUBLIC

MY COMMISSION EXPIRES: _____



TOWN OF CASTLE ROCK

ATTEST:

BY: AS MAYOR AND

AS TOWN CLERK

SUBSCRIBED AND SWORN TO BEFORE ME THIS 28th DAY OF April, 2004

BY:

ATTEST: TOWN CLERK

WITNESS MY HAND AND OFFICIAL SEAL.

NOTARY PUBLIC _____

MY COMMISSION EXPIRES: _____

TITLE CERTIFICATE

I, LYNDA J. ROSSAMOND AN AUTHORIZED REPRESENTATIVE OF

North American Title Company A TITLE INSURANCE COMPANY LICENSED TO DO BUSINESS ¹

² OWNERS, MORTGAGEES AND LIEN HOLDERS OF THE PROPERTY ARE LISTED IN THE CERTIFICATION OF OWNERSHIP AND DEDICATION.

SIGNED THIS 23rd DAY OF September, 2002

AUTHORIZED REPRESENTATIVE

North American Title Company
TITLE INSURANCE COMPANY

¹ IN THE STATE OF COLORADO, HAVE MADE AN EXAMINATION OF THE PUBLIC RECORDS AND STATE THAT ALL ²

STATEMENT OF TOWN APPROVAL AND ACCEPTANCE

ON BEHALF OF THE TOWN OF CASTLE ROCK, COLORADO, I HEREBY CERTIFY THAT THIS PLAT WAS APPROVED IN ACCORDANCE WITH ALL APPLICABLE REGULATIONS AND THAT THE DEDICATIONS ON THIS PLAT ARE HEREBY ACCEPTED BY THE TOWN.

ATTEST:
 TOWN CLERK

TOWN OF CASTLE ROCK
 TOWN MANAGER

STATEMENT OF COMMUNITY DEVELOPMENT DIRECTOR'S APPROVAL

THIS PLAT WAS APPROVED BY THE COMMUNITY DEVELOPMENT DIRECTOR OF THE TOWN OF CASTLE ROCK, COLORADO, THE 27th DAY OF December, 2003

COMMUNITY DEVELOPMENT DIRECTOR

DOUGLAS COUNTY CLERK AND RECORDERS CERTIFICATE

THIS PLAT WAS FILED FOR RECORD IN THE OFFICE OF THE COUNTY CLERK AND RECORDER OF DOUGLAS COUNTY AT 11:14 A.M. ON THE 26th DAY OF MAY, 2004.

BOOK _____ PAGE _____ RECEPTION NO. 2004053764

DOUGLAS COUNTY CLERK AND RECORDER

BY: DEPUTY

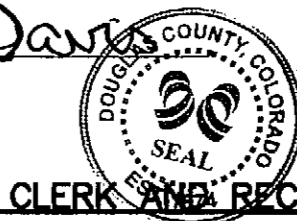

TOWN OF CASTLE ROCK CLERK AND RECORDERS CERTIFICATE

ATTEST: BY: _____ TOWN CLERK

WITNESS MY HAND AND OFFICIAL SEAL.

NOTARY PUBLIC _____

MY COMMISSION EXPIRES: _____

OWNERS
US HOME CORPORATION
9990 PARK MEADOWS DRIVE
LONE TREE, CO 80124

TOWN OF CASTLE ROCK
100 WILCOX
CASTLE ROCK, CO 80104

DEVELOPER/APPLICANT
US HOME CORPORATION
9990 PARK MEADOWS DRIVE
LONE TREE, CO 80124

SHEET INDEX
SHEET 1 OF 2 COVER SHEET/NOTES
SHEET 2 OF 2 TRACT LAYOUT



HIGH COUNTRY ENGINEERING, INC.
14 INVERNESS DRIVE EAST, SUITE D-136
ENGLEWOOD, COLORADO 80112
PH (303) 925-0544 FX (303) 925-0547

RED HAWK FILING NO. 2, 1ST AMENDMENT
CORRECTION OF TRACT OWNERSHIP
SHEET 1 OF 2

