

SITE DEVELOPMENT PLAN, AMENDMENT NO. 1 HILLSIDE / ARBORS SITE DEVELOPMENT PLAN

LOCATED IN THE SOUTHWEST 1/4 OF SECTION 3 AND THE SOUTHEAST 1/4 OF SECTION 4, TOWNSHIP 8 SOUTH, RANGE 67 WEST OF THE 6th P.M.,
TOWN OF CASTLE ROCK, COUNTY OF DOUGLAS, STATE OF COLORADO

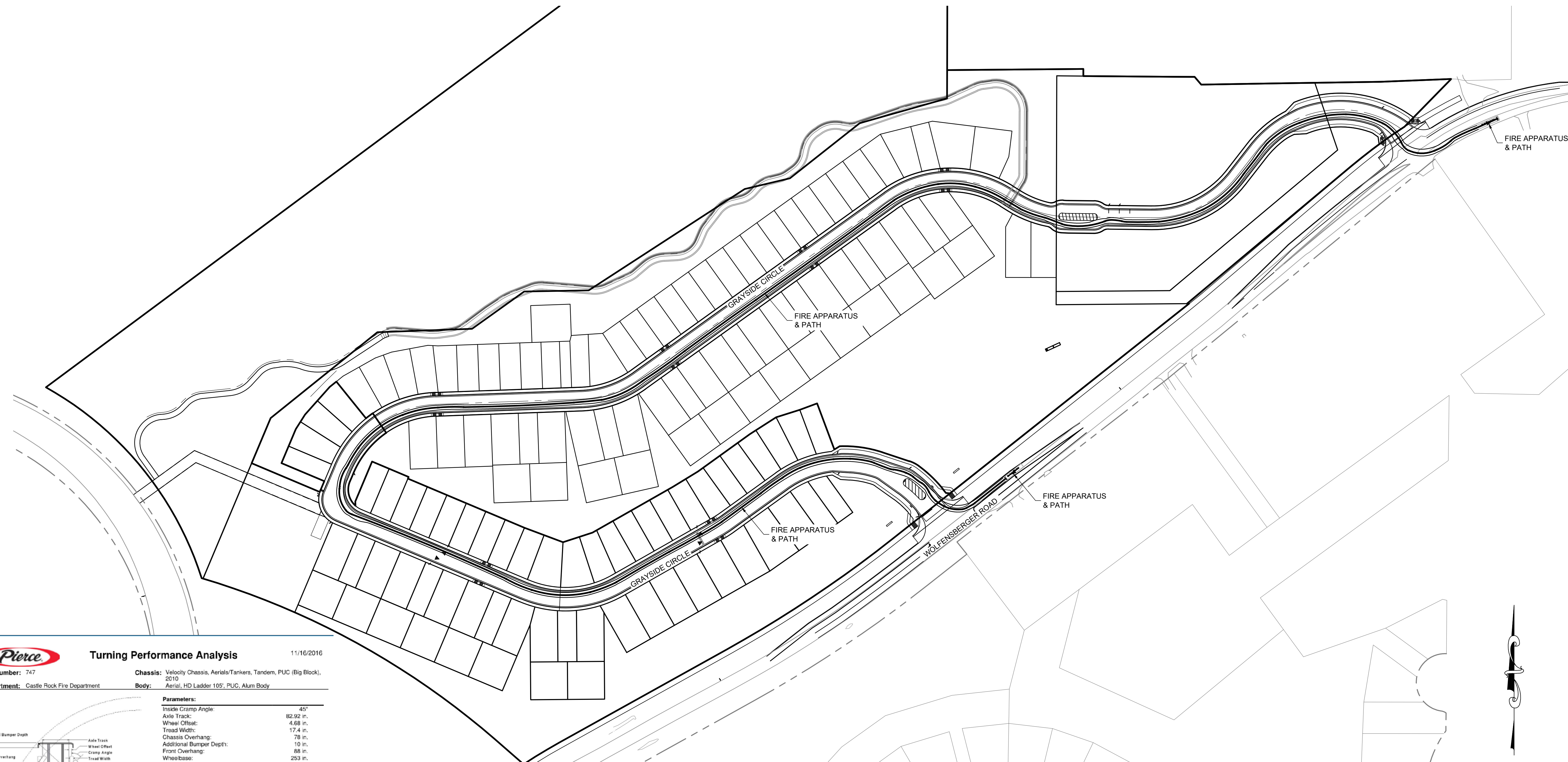

Turning Performance Analysis

11/16/2016

Bid Number: 747
Department: Castle Rock Fire Department

Chassis: Velocity Chassis, Aerials/Tankers, Tandem, PUC (Big Block), 2010
Body: Aerial, HD Ladder 105', PUC, Alum Body

Parameters:

Inside Cramp Angle: 45°
Axle Track: 82.92 in.
Wheel Offset: 4.68 in.
Tread Width: 17.4 in.
Chassis Overhang: 78 in.
Additional Bumper Depth: 19 in.
Front Overhang: 88 in.
Wheelbase: 253 in.

Calculated Turning Radii:

Inside Turn: 19 ft. 0 in.
Curb to curb: 36 ft. 2 in.
Wall to wall: 40 ft. 8 in.

Comments:

Apparatus Width: 96.00 inches
Apparatus Length: 42' 9.5"
Lock to Lock time: 6.00

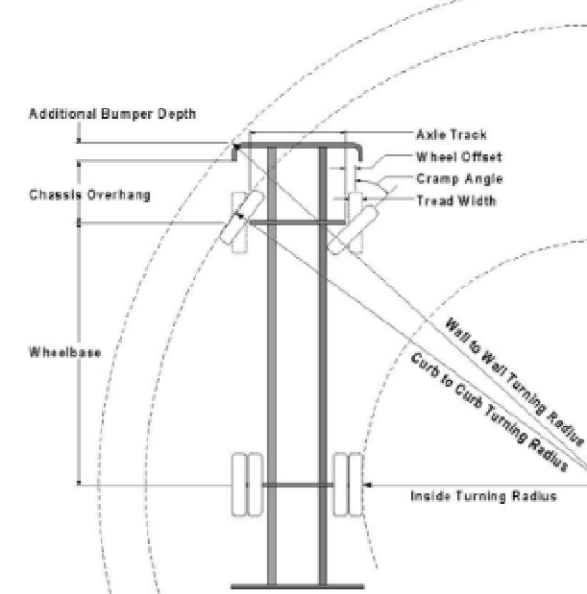

Category	Option	Description
Axle, Front	0508849	Custom
Wheels, Front	0319811	Alcoa, 22.5" x 12.25", Aluminum, Hub Pilot
Tires, Front	0664500	Goodyear, G296 MSA, 425/65R22.5, 20 ply, Fire Service Speed Rtg
Bumpers	0790541	10" Extended, Steel Painted, 12" High, Imp/Val
Aerial Devices	0673136	Aerial, 105' Heavy Duty Ladder, (750 dry/500 water)

Notes:
Actual inside cramp angle may be less due to highly specialized options.
Curb to Curb turning radius calculated for 9.00 inch curb.

EES
ENTITLEMENT AND
ENGINEERING
SOLUTIONS, INC.
501 S Cherry St
Suite 300
Glendale, CO 80246
www.ees.us.com
303-572-7997

FIRE APPARATUS
EXHIBIT
HILLSIDE / ARBORS
PROJECT NO. SDP22-2018